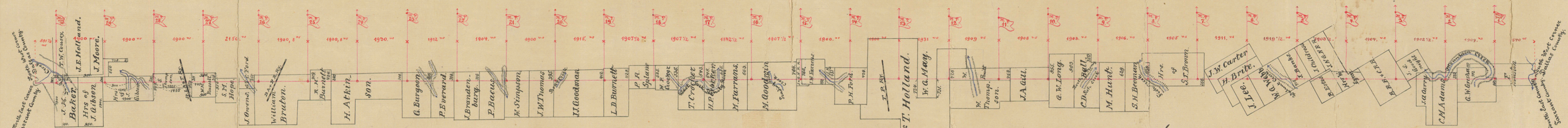

Exhibit B.

Map showing boundary line between Dallas and Tarrant County, established October 1890. Scale: 2000 feet to 1 inch.



J.M. Strong
Special Surveyor for Dallas County.

Goodfellow.
Special Surveyor for Tarrant County.

Filed in the Genl Land Office
January 2nd 1891.

J. M. Shiley
CHIEF CLERK