

Plays written & owned by Wilfred Clarke

Tit For Tat..... 3 Act Comedy
(Produced, Ford's Theatre, Balto. 1893)

A Wise Woman..... 3 Act Comedy
(Produced, Girard Ave. Theatre, Phila 1894)

A New York Divorce..... 3 Act Comedy
(Produced, Strand Theatre. London, 1895)

A Tale of a Tub (afterwards ' Oh, Sussannah!)
3 Act Comedy
(Produced., Theatre Royal, Cambridge 1896)

VAUDEVILLE SKETCHES,
that have been played.

In The Biograph..... 2 Years.

When The Lights Went Out!..... 1 Year

No More Trouble..... 2 Years.

How Will It All End..... 1 Year.

What Will Happen Next..... 8 Years.

The Dear Departed..... 1 Year.

A Wife For An Hour..... 1 Year.

WILFRED CLARKE

Mr. Wilfred Clarke, was born in 1867 at Philadelphia. He is the grandson of Junius Brutus Booth, the nephew of Edwin Booth, and son of John Sleeper Clarke. He is part owner of the Walnut St, Theatre, Philadelphia

Extract from Phila. Item

Aug. 1899

WILFRED CLARKE

LEADING COMEDIAN WITH.

- 1884 - John S. Clarke, Strand Theatre, London.
1884 - 85 - 85 - Barry Sullivan, Tour.
1887 - Alexandra Theatre, Liverpool, Stock.
1887 - Standard Theatre, London, Stock.
1887 - 88 - Creston Clarke, Tour.
1888 - 89 - Frederick Warde, Tour.
1889 - 90 - Booth-Barrett, New York & Tour.
1890 - 91 - Litt Stock, Minn. & St Paul.
1891 - John T. Ford Stock, Balto. Md.
1891 - 92 - Julia Marlow, New York & Tour.
1892 - 93 - Starring, John T. Ford, Mgr.
1893 - 94 - - 95 - Starring, Personal Management.
1895 - Girard Ave. Theatre, Phila, Stock Star.
1895 - 96 - Strand Theatre, London, Lessee & Star.
1896 - 97 - Strand Theatre, London, Clarke & Paulton Mgrs.
1887 - Strand Theatre Co. Tour. Clarke & Paulton, Mgrs.
1867 - 98 - 99 - Augustin Daly Co., New York.
1899 - 1900 - Ada Rehan Shakesperian Co, Tour & New York.
1900 - 01 San Toy, Daly's Theatre, New York.
1901 - 02 - Vaudeville Headliner.
1902 - 03 - Grand Opera House, Frisco. Stock Star.
1903 - to - 1910 - Vaudeville Headliner.
1910 - Lady from Lobster Sq. Weber's, New York,
1910 - 11 - 12 - Vaudeville Headliner,
1912 - Just Like John, 48th St Theatre, New York.
1913 - Vaudeville Headliner.

WILFRED CLARKE

SOME OF THE PARTS PLAYED

- Peter Amos Dunn in Niobe.
Washington Phipps in Banker's Daughter.
Cis Farringdan in The Magistrate.
Mr. Posket in The Magistrate.
Banbury Kobb in Rosedale.
Tony Lumkin in She Stoops to Conquer.
Dr. Pangloss in Heir at Law.
Paul Pry in Paul Pry.
Henry Graves in Money
Bob Acres in The Rivals.
Simon Clegg in The World Against Her.
Sir Andrew Aguecheck in Twelfth Night.
Launcelot Gobbo in The Merchant of Venice.
Grumio in Taming of the Shrew.
Tonchstone in As You Like It,
First Gravedigger in Hamlet.
Slender in Merry Wives of Windsor.
Robert Blackmoore. (original) in Othello.
Dick Whortles, (original) in Number Nine,
Lord Coodle, (original) in The Runaway Girl.
Sir Bingo Preston, [original] in San Toy.
Henry Rawlins, [original] in Uncles and Aunts.
Lord Montyghall, [original] in The Great Ruby.
Bob Briely in Ticket of Leave Man
Airy in The Last Word.
Mr. Hummingtop in Arabian Nights.
Augustus Pillberry in Lady From Lobster Sq.
Montague Baxter in Just Like John.

**INTERSTATE
AMUSEMENT
COMPANY**

Majestic Theatre Building
Chicago, Ill.

Name of Act **WILFRED CLARKE & CO.,**

NO. OF PERSONS **FOUR**

NO. OF DRESSING ROOMS **(3)**

TIME OF ACT FULL STAGE **15 min.**

TIME OF ACT IN ONE

BILLING AND DESCRIPTION OF ACT

WILFRED CLARKE & CO.,
Presenting Mr. Clarke's Farce
"WHAT WILL HAPPEN NEXT"

SCENE PLOT

AS ATTACHED HERETO

PROGRAMME COPY

CAST

Bertie Bluffington-----Wilfred Clarke
Salena, the wife-----Helen Aynslie
Peter Rolleston-----Frank Herbert
Ada, the cause-----Grace Menken

PROPERTY PLOT

AS ATTACHED HERETO

THE SKETCH

The basis of the fun-making in "What Will Happen Next" is the conduct of a flirtatious young husband, Bertie Bluffington, who, while stimulated by champagne, brings to his home a young married woman whom he had met at a fancy ball. To keep the knowledge of her presence from his wife is difficult, and is rendered more embarrassing by the action of his friend, Peter Rolleston, who turns out to be the husband of the unknown. The piece is purely farcical in design, and is so cleverly constructed that action and dialogue run a merry race to the finish. To enactment of such a trifle, to be effective, demands quick touch and go on the part of the players, and this essential was so happily provided that the performance rattled along on a breeze of humor that kept spectators in a laughing mood. Mr. Clarke's appropriate dressing of the stage gives a fresh and inviting aspect to it.

WILFRED CLARKE: Son of John S. Clarke, Nephew of Edwin Booth. Part owner of Walnut St. Theatre, Philadelphia. Educated at St. Croix College, Paris, France, and Dulwich College, England. Leading comedian with Barry Sullivan, Edwin Booth, Lawrence Barrett, Julia Marlow, Ada Rehan, and Augustin Daly's New York Co., filling the position left vacant by the late James Lewis.

WILFRED CLARKE CO.

Name of Act..... Wilfred Clarke Co.
Name of Sketch..... What Will Happen Next!
Open and Close In..... Full.
Time..... 15 Minutes.
Dressing Rooms (3) Three.

SCENE PLOT

Handsome Light Parlor
2 Arches
2 Doors (DR 2 with Practical Lock)
2 Jogs
1 French Window
3 Interior Backings
1 House Top Backing

PROPERTY PLOT

Ground Cloth, or Medallion
Library Table (2 ft. 6 in. long)
Settee (3 ft. ~~6~~ long)
Tabourette (18 in. high, very strong)
1 Very High Straight Backed Chair (no Arms)
3 Square Backed Chairs (no Arms)
2 Pedestals
1 Rattan Couch (no Back or Casters)—**MOST IMPORTANT!**
1 Small Table
3 Plants
3 Sofa Pillows
1 Fancy Hat Tree—**MOST IMPORTANT!**
2 Curtain Poles (wider than Arches)
Practical Lock and Key (on DR 2)
3 Bandboxes (10 in. high)
1 Newspaper
1 Kitchen Table (Off Stage)

LIGHT PLOT

Full Up Throughout
1 Amber Flood from Front
1 Amber Medium (on Stage)
3 White Bunches Off Arches

Warning Cue.—"My Husband's in there with Your Wife."
Curtain Cue.—"To love, honor and support me? Yes, yes, forever!"
4 Very Quick Curtains

THE SKETCH

The basis of the fun-making in "What Will Happen Next" is the conduct of a flirtatious young husband, Bertie Bluffington, who, while stimulated by champagne, brings to his home a young married woman whom he had met at a fancy ball. To keep the knowledge of her presence from his wife is difficult, and is rendered more embarrassing by the action of his friend, Peter Rolleston, who turns out to be the husband of the unknown. The piece is purely farcical in design, and is so cleverly constructed that action and dialogue run a merry race to the finish. To enactment of such a trifle, to be effective, demands quick touch and go on the part of the players, and this essential was so happily provided that the performance rattled along on a breeze of humor that kept spectators in a laughing mood. Mr. Clarke's appropriate dressing of the stage gives a fresh and inviting aspect to it.

WILFRED CLARKE: Son of John S. Clarke, Nephew of Edwin Booth. Part owner of Walnut St. Theatre, Philadelphia. Educated at St. Croix College, Paris, France, and Dulwich College, England. Leading comedian with Barry Sullivan, Edwin Booth, Lawrence Barrett, Julia Marlow, Ada Rehan, and Augustin Daly's New York Co., filling the position left vacant by the late James Lewis.

WILFRED CLARKE CO.

Name of Act..... Wilfred Clarke Co.
Name of Sketch..... What Will Happen Next!
Open and Close In..... Full.
Time..... 15 Minutes.
Dressing Rooms (3) Three

SCENE PLOT

Handsome Light Parlor
2 Arches
2 Doors (DR 2 with Practical Lock)
2 Jogs
1 French Window
3 Interior Backings
1 House Top Backing

PROPERTY PLOT

Ground Cloth, or Medallion
Library Table (2 ft. 6 in. long)
Settee (3 ft. ~~6~~ long)
Tabourette (18 in. high, very strong)
1 Very High Straight Backed Chair (no Arms)
3 Square Backed Chairs (no Arms)
2 Pedestals
1 Rattan Couch (no Back or Casters)—MOST IMPORTANT!
1 Small Table
3 Plants
3 Sofa Pillows
1 Fancy Hat Tree—MOST IMPORTANT!
2 Curtain Poles (wider than Arches)
Practical Lock and Key (on DR 2)
3 Bandboxes (10 in. high)
1 Newspaper
1 Kitchen Table (Off Stage)

LIGHT PLOT

Full Up Throughout
1 Amber Flood from Front
1 Amber Medium (on Stage)
3 White Bunches Off Arches

Warning Cue.—"My Husband's in there with Your Wife."

Curtain Cue.—"To love, honor and support me? Yes, yes, forever!"

4 Very Quick Curtains

**INTERSTATE
AMUSEMENT
COMPANY**

Majestic Theatre Building
Chicago, Ill.

Name of Act **IL**

NO. OF PERSONS **FOU**

TIME OF ACT FULL STAGE

BILLING AND DESCRIPTION OF ACT

WILFRED CLARKE & CO.,
Presenting Mr. Clarke's Farce
"WHAT WILL HAPPEN NEXT"

SCENE PLOT

AS ATTACHED HERETO

THE SKETCH

The basis of the fun-making in "What Will Happen Next" is the conduct of a flirtatious young husband, Bertie Bluffington, who, while stimulated by champagne, brings to his home a young married woman whom he had met at a fancy ball. To keep the knowledge of her presence from his wife is difficult, and is rendered more embarrassing by the action of his friend, Peter Rolleston, who turns out to be the husband of the unknown. The piece is purely farcical in design, and is so cleverly constructed that action and dialogue run a merry race to the finish. To enactment of such a trifle, to be effective, demands quick touch and go on the part of the players, and this essential was so happily provided that the performance rattled along on a breeze of humor that kept spectators in a laughing mood. Mr. Clarke's appropriate dressing of the stage gives a fresh and inviting aspect to it.

WILFRED CLARKE: Son of John S. Clarke, Nephew of Edwin Both. Part owner of Walnut St. Theatre, Philadelphia. Educated at St. Croix College, Paris, France, and Dulwich College, England. Leading comedian with Barry Sullivan, Edwin Booth, Lawrence Barrett, Julia Marlow, Ada Rehan, and Augustin Daly's New York Co., filling the position left vacant by the late James Lewis.

WILFRED CLARKE CO.

Name of Act..... Wilfred Clarke Co.
Name of Sketch..... What Will Happen Next!
Open and Close In..... Full.
Time..... Dressing Rooms (3) Three 15 Minutes.

SCENE PLOT

- Handsome Light Parlor
- 2 Arches
- 2 Doors (DR 2 with Practical Lock)
- 2 Jogs
- 1 French Window
- 3 Interior Backings
- 1 House Top Backing

PROPERTY PLOT

- Ground Cloth, or Medallion
- Library Table (2 ft 6 in. long)
- Settee (3 ft. ~~6~~ long)
- Tabourette (18 in. high, very strong)
- 1 Very High Straight Backed Chair (no Arms)
- 3 Square Backed Chairs (no Arms)
- 2 Pedestals
- 1 Rattan Couch (no Back or Casters)—MOST IMPORTANT!
- 1 Small Table
- 3 Plants
- 3 Sofa Pillows
- 1 Fancy Hat Tree—MOST IMPORTANT!
- 2 Curtain Poles (wider than Arches)
- Practical Lock and Key (on DR 2)
- 3 Bandboxes (10 in. high)
- 1 Newspaper
- 1 Kitchen Table (Off Stage)

SPOT LIGHT CUES FOR WM. SCHILLING & CO.

IN

"DESTINY"

By J. R. SHANNON

Warning--When woman chokes man over table.

When foot out, direct cue for--Green Spot Light on man and follow until finish of act.

Stage Manager's Cues

WM. SHILLING & CO.

Curtain Cues

Take curtain up when gong starts striking eleven. Take up slowly.

Have Snow Cradle working at same time.

Warning--second pistol shot.

Curtain Cue ----- "DESTINY"

Curtain down slowly and hold down until man gets up to standing position.

3 Dressing rooms for five people.

Set of lines in one.

Centre line for Chandelier in 2½ or 3.

1--set in four for snow cradle.

Trip set in four for ceiling peice.

Set in four for flat.

Set in four and half for drop.

3--Backins

Electrician Cues

WM. SCHILLING & CO.

At opening of act all foots out, dome and brackets lit all through act when second woman enters foots up quarter or half up. Will warn you.

6 Plugs.

Baby spot for fire place (red medium)

Strip back of window blue lamps,

Bunch light back of drop.

Strip or bunch light for hallway.

Bunch light for left door.

Warning for foots out is when women chokes man across table--Cue you shant go--Woman at centre door, then all foots out.

PROPERTYMAN CUE

For Wm. Shilling & Co.

CUE--SECOND PISTOL SHOT.

STRIKE GONG 12 TIMES.

Break four every show

- 1 Dozen Whiskey Glasses
- 1 Desk Telephone
- 1 Clock for Mantle
- 2 Vases for Mantle medium size
- 2 Large Figures about 4 feet high or large busts
- 2 Natural Palms Three feet high
- 1 Small Fern
- 1 Ordinary Book
- 1 Auto Horn
- 1 Large brass pipe for gong effect
- 1 Set of Chimes
- 1 Police Patrol gong
- 1 Bag of Salt
- 1 Large Screen or Backing for change at Right entrance up
- 1 Small Smoking Stand
- Artificial Flowers
- Fire and irons, tongs, rail and brass scuttle
- 2 Large basket bouquet holders

1 set Sleigh Bells

14 ft step ladder

Thanking you in advance, as these props. are essential.

WM. SCHILLING.

PROPERTY LIST FOR
WM. SCHILLING & CO.

IN HIS DRAMATIC SENSATION

"DESTINY"

By J. R. SHANNON

-
- 1 Overstuffed Leather Couch High Head
 - 1 Overstuffed Leather Arm Chair Large
 - 1 Overstuffed Leather Rocker Large
 - 1 Overstuffed Leather Morris Chair Large
 - 3 Fur Rugs 2 White Ones 1 Black One
 - 1 Tiger Skin Rug or 2 Leopard Skin Rugs
 - 7 Oriental Rugs
 - 1 Large Madilion Red preferred
 - 1 Large Dark Mission Cellarette Or a Serving table must be high
 - 1 Mission Hall Clock
 - 1 Large Mission Library Table with drawer must have drawer
 - 3 Pedestals Mission
 - 3 Brass Jardiners Stands and Jardiners Either Brass or China
 - 2 Leather Hassacks if you can't get Leather get Carpet ones
 - 1 Mission Bookcase Dressed
 - 1 Ladies Writing Desk and Chair
 - 1 Brass Costumer
 - 2 Nickel Trays
 - 6 Whiskey bottles 2 filled half with Sugar water others empty
Break four every show
 - 1 Dozen Whiskey Glasses
 - 1 Desk Telephone
 - 1 Clock for Mantle
 - 2 Vases for Mantle medium size
 - 2 Large Figures about 4 feet high or large busts
 - 2 Natural Palms Three feet high
 - 1 Small Fern
 - 1 Ordinary Book
 - 1 Auto Horn
 - 1 Large brass pipe for gong effect
 - 1 Set of Chimes
 - 1 Police Patrol gong
 - 1 Bag of Salt
 - 1 Large Screen or Backing for change at Right entrance up
 - 1 Small Smoking Stand
 - Artificial Flowers
 - Fire and irons, tongs, rail and brass scuttle
 - 2 Large basket bouquet holders

1 set Sleigh Bells

14 ft step ladder

Thanking you in advance, as these props. are essential.

WM. SCHILLING.

**INTERSTATE
AMUSEMENT
COMPANY**

Majestic Theatre Building
Chicago, Ill.

Name of Act INEZ McCAULEY & CO.

NO. OF PERSONS THREE

NO. OF DRESSING ROOMS 2

TIME OF ACT FULL STAGE Full stage.

TIME OF ACT IN ONE

BILLING AND DESCRIPTION OF ACT

INEZ McCAULEY & CO.,
In
"The Girl From Childs"

SCENE PLOT

AS ATTACHED HERETO.

PROGRAMME COPY

INEZ McCAULEY & CO.,
In
"THE GIRL FROM CHILDS"
An up to the minute comedy by
Archie Colby.

C A S T

Mr. Henry Bull---Geo. B. Connor
Mrs. Henry Bull---Henrietta
Dickinson
Mary Butts (The Girl from Childs)
-----Inez McCauley.
Scene:--Dining room in H. Bull's
Apt.
Time;--Present.

PROPERTY PLOT

AS ATTACHED HERETO

REMARKS
Classes and silverware for sideboard. 1 Morris chair (important)
1-3 Foot pedestal
1 Small palm.

WEEK OF

May 25-26-27

(Stage Plot)

~~INEZ McCAULEY & CO.~~ - INEZ MACAULEY & CO.
"THE GIRL FROM CHILDS"

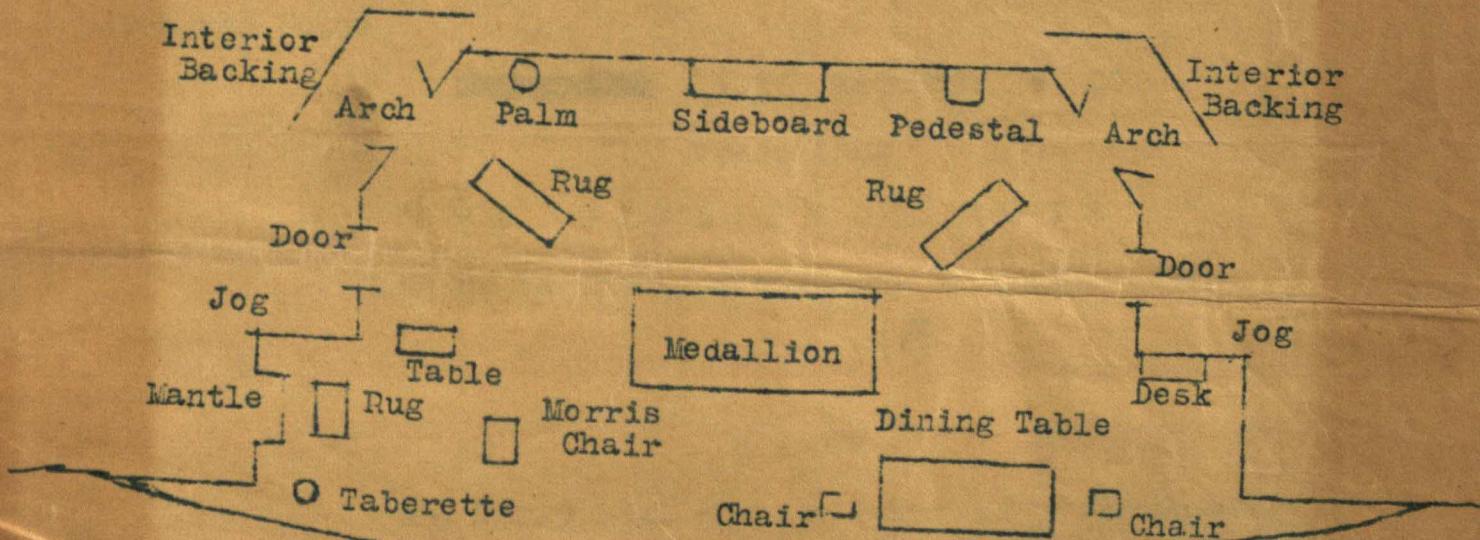

WEEK OF

May 25-26-27

SCENE:- Dining room in Henry Bull's apartment, New York City

TIME:- Present.

WEEK OF

May 25-26-27

(Property Plot)

~~THE GIRL FROM CHILDS~~ - INEZ MACAULEY & CO.

I N

"THE GIRL FROM CHILDS"

PROPS.

dinner

- 2 ~~Fancy~~ Plates
- 2 Silver Knives
- 2 Silver Forks
- 2 Silver Tablespoons
- 2 Silver Teaspoons
- 2 Water glasses
- 2 Wine glasses
- 1 Clean white table cloth
- 4 Clean white napkins
- 2 Fancy Soup ~~dishes~~ plates
- 2 Silver salt and pepper shakers
- 1 Silver serving tray
- 1 Tap bell
- 1 Brass smoking set
- 1 Desk telephone
- 1 Vase for flowers
- 1 Scratch pad and pencil
- 1 Mantle clock
- Framed photograph for mantle
- 1 Telephone bell (outside)
- 1 Thump board
- Glasses and silverware for sideboard.

- 3 Carpet rugs
- 1 Meat platter (*small*)
- 1 ~~Cut glass punch bowl~~
- 1 ~~Glass celery dish~~
- 1 Fancy bread plate
- 1 Newspaper
- 1 Change table for props

Suit Case

FURNITURE

- 1 Small dining table (for two)
- 4 Straight back dining chairs
- 1 Fancy sideboard and cover
- 1 Fancy hat-rack
- 1 lady's writing desk
- 1 Chair for desk
- 1 Mantle
- 1 small taberette
- 1-24 inch table *fancy electric table lamp*
- 1 ~~Electric fan and shade~~
- 1 Morris chair (Important)
- 1-3 Foot pedestal
- 1 Small palm.

REMARKS

WEEK OF

May 25-26-27

(Stage Plot)

~~THE GIRL FROM CHILDS~~ - INEZ MACAULEY & CO.

"THE GIRL FROM CHILDS"

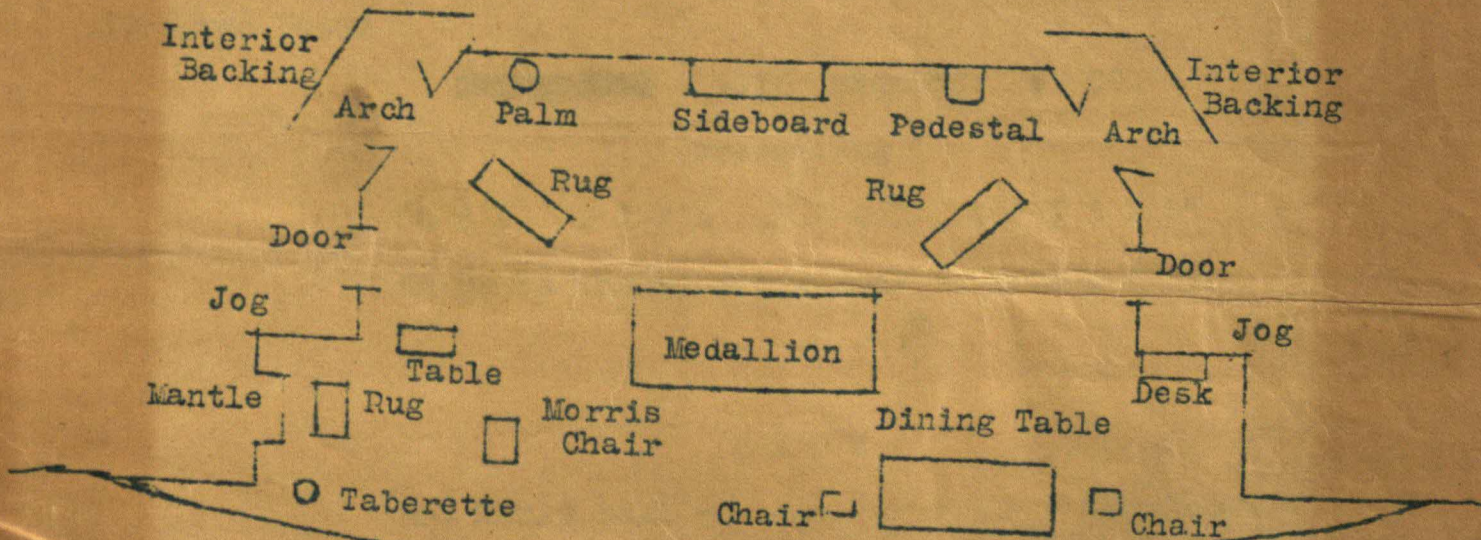

WEEK OF

May 25-26-27

SCENE:-

Dining room in Henry Bull's apartment, New York City

TIME:-

Present.

WEEK OF

May 25-26-27

(For Stage Manager.)

~~XXXXXXXXXX~~ - INEZ MACAULEY & CO.

I N

"THE GIRL FROM CHILDS"

SET. Use 2 arch fancy, either light or dark set in three, with doors right and left third, jog in 2, and carry off from that both sides the same.

ELECTRIC. Please have electric switch button on up stage side of door RIGHT THIRD.

LIGHTS. Use your house chandelier as it is important. Lights full up all through until cue "HE SURE DOES." then all lights out on stage except glow in fireplace and up stage bunches.

CURTAIN CUE. "IRISH STEW". (~~Watch Mrs. Bull.~~)

*3 people
2 dressing rooms*

WEEK OF May 25-26-27

(Program Copy)

~~XXXXXXXXXX~~ - INEZ MACAULEY & CO.

Presenting

"THE GIRL FROM CHILDS"

An up to the minute comedy by Archie Colby.

- - - - -

C A S T

Mr. Henry Bull - - - - -	<i>George B. Connor</i>
Mrs. Henry Bull - - - - -	<i>Henrietta Dickinson</i>
Mary Butts (The girl from Childs)	Inez Macauley.

SCENE:- Dining room in Henry Bull's apartment, New York City

TIME:- Present.

WEEK OF May 25-26-27

- - - - -

MACLYN ARBUCKLE
FOR PROPERTY MAN.

- ✓ Sideboard R. of Centre Opening.
- ✓ Dining Table R.C., Large enough for two with (table must be round) IMPORTANT.
- ✓ Clean White Cloth Spread.
- ✓ Small Fern on Table.
- ✓ Fireplace and mantel-piece L.
- ✓ Armchair L. C.
- ✓ Settee Up L.
- ✓ Armchair Down R.
- ✓ 1 Chair L. of Table.
- ✓ Telephone (Bell to Ring) R. of C. Door (Wall Phone, not a Hand Phone).
Cue for Phone Bell to Ring, "It's time to drop the flag, Bo."
- ✓ Portieres at Door C. which are open.
- ✓ 1 Small Pitcher of Water.
- ✓ Scotch Whiskey Bottle Half-filled with Cold Tea.
- ✓ Cracked Ice in Glass Pitcher.
- ✓ High Ball Glasses, Wine Glasses, etc.
- ✓ Wine Cooler (Inside Sideboard). *(metal)*
- ✓ 2 Champagne Bottles Unopened and must look like the real thing.
Bottles are not opened. These could be borrowed and returned after Act. Off R. *(Quart size)*
- ✓ 12 Large Table Knives.
- ✓ 12 Large Forks.
- ✓ 2 Soup Spoons.
- ✓ 2 Desert Spoons.
- ✓ 2 Oyster Forks.
- ✓ 2 Sherry Glasses.
- ✓ 2 Champagne Glasses.
- ✓ 2 Port Wine Glasses.
- ✓ 2 Large Napkins (in L. hand drawer of Sideboard).
- ✓ 2 Dinner Plates (on Sideboard)
- ✓ 1 Match-stand with Matches.
- ✓ 2 Butter Plates (Patties)
- ✓ 1 Hat Rack outside C. Opening.
- ✓ 1 Match-stand on Mantelpiece.
- ✓ 1 Large Bowl for Ice Cream off R.
- ✓ 1 Silver Tray for Ice Cream Bowl off R.
- ✓ 2 Large Table Spoons off R.
- ✓ 1 napkin to Cover Bowl.
- All Silver and Glassware, etc., must look first class.
Decorate Sideboard with High Ball Glasses, etc., to look hospitable and first class.
- ✓ Please get Mission Furniture.
- ✓ 2 Glass Vases for Flowers.

Table
Chair □ □ Chair

sofa

Fire Place
Red Glass

Other furniture to dress stage. Handsome drawing-room in fashionable New York Hotel. Portieres must slide easily on pole, for business.

SCENE PLOT.

"THE ACE OF TRUMPS."

Frank A. Ferguson and Co.

Back Drop. Park or Street scene.

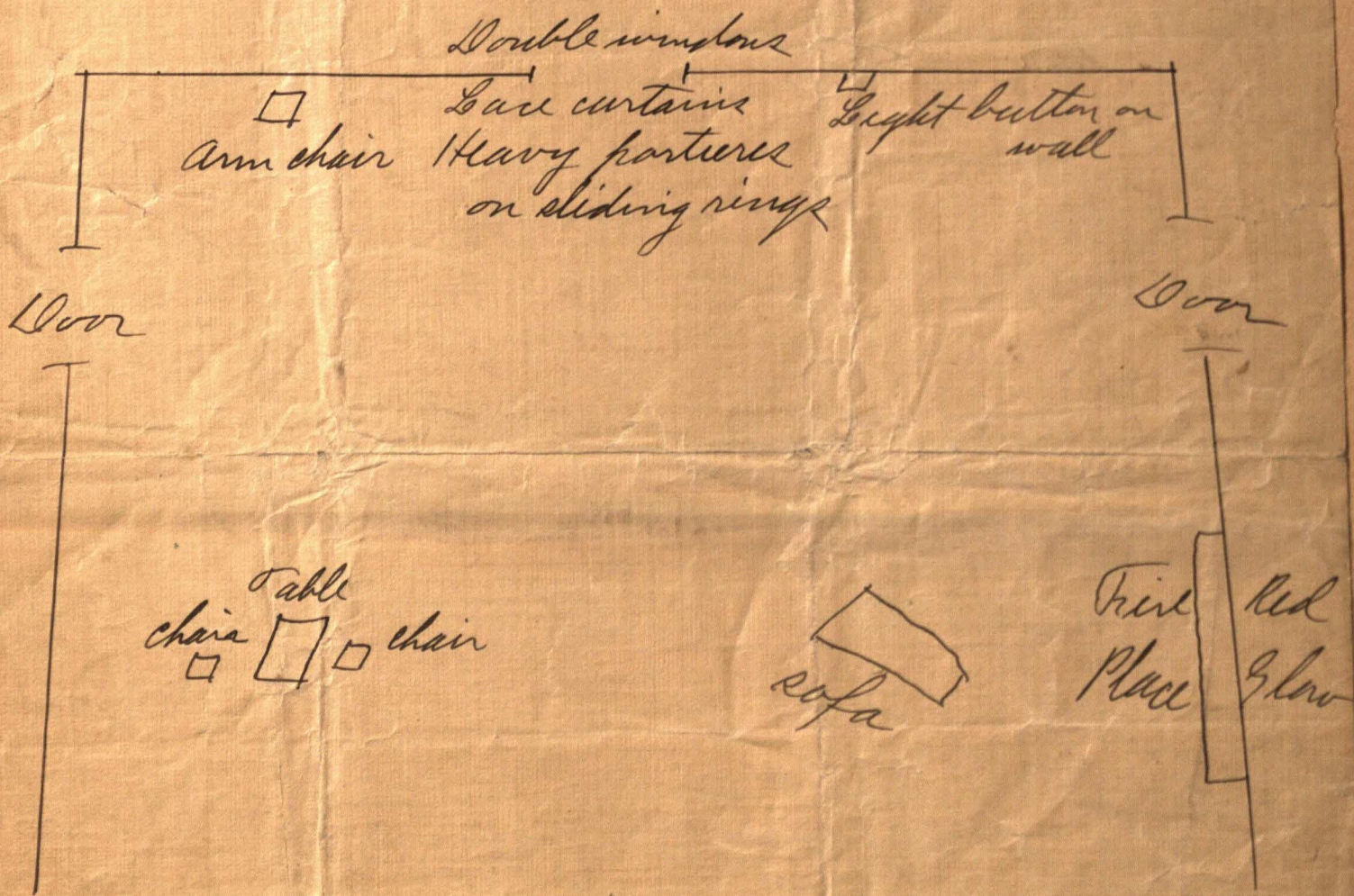

Other furniture to dress stage. Handsome drawing-room in fashionable New York Hotel. Portieres must slide easily on pole, for business.

ORPHEUM CIRCUIT PRODUCTIONS

Senior Combination No. 5

STAGE MANAGER

10 Dressing rooms (to dress 22 people) 10 Minutes
 Time of FERRY act 8 Minutes
 Time of Pearson Bro. act. 18 Minutes
 Time of Kraft & LaMonte act 20 Minutes
 Time of London-Paris-New York act

Williams
PLOTS *12 11*

CARPENTER NOTE:—This show uses 25 sets of lines in a depth of 16 feet starting 18" back of the working curtain. This does not include trips for one Cyc. Kindly have as clear a loft as possible and save much time and trouble upon opening day. We also use the entire back wall to work these acts properly.

*Clear Loft and Stage.
 Please arrange to have*

1 set of lines	18" back of the working curtain
" " " "	21" " " " " "
" " " "	24" " " " " " "
" " " "	30" " " " " " "
" " " "	36" " " " " " "
" " " "	42" " " " " " "
" " " "	4' 0" " " " " " "
" " " "	4' 6" " " " " " "
" " " "	6' 6" " " " " " "
" " " "	7' 0" " " " " " "
" " " "	7' 6" " " " " " "
" " " "	8' 0" " " " " " "
" " " "	8' 6" " " " " " "
" " " "	9' 0" " " " " " "
" " " "	9' 6" " " " " " "
" " " "	10' 0" " " " " " "
" " " "	12' 0" " " " " " "
" " " "	12' 6" " " " " " "
" " " "	13' 0" " " " " " "
" " " "	13' 6" " " " " " "
" " " "	14' 0" " " " " " "
" " " "	14' 6" " " " " " "
" " " "	15' 0" " " " " " "
" " " "	15' 6" " " " " " "
" " " "	16' 0" " " " " " "

Have 5 trucks at the car at 8 A.M. Denver Eastworth R. R.
 Call Crew 9 A.M. John Harris Carpenter.

*Yellow Card.
 2 2 4 Carpet.
 3 3 3 Elect
 2 2 2 Props.*

PROPERTY DEPARTMENT

- 6 hall trees
 - 4 chairs
 - 4 kitchen tables
 - 4 mirrors
 - 1 tree stump
 - 2 beer boxes
 - ~~2 egg crates~~
 - 2 different tone auto horns
- } For Change Rooms

ELECTRIC DEPARTMENT

- 200 Amps for Co. switch board
- 2 lights for change rooms
- 1 16 ft. step ladder (Must Have)

Orpheum Circuit Productions

Junior Combination No. 6

PLOTS

Stage Manager

We require seven (7) rooms to dress 14 people
Time of WILLS & HOLMES Act - - - - - 12 minutes
Time of DELANO DELL & CO. Act - - - - - 25 minutes
Time of DOC BAKER REVUE - - - - - 25 minutes

Call 2-2041 Stake Trucks at the car at 9 A.M. ~~_____~~ R. R.

Call crew _____ M.

Paulo Fe

~~_____~~

GB Hagin

Carpenter.

STAGE CARPENTER

This show uses and must have 27 sets of lines, not including the regular house trips. Therefore tape off and have sets empty upon our arrival. Using top battens on all sets except seven (7).

Two house interior backings—Two palace wings each side.

Two wood wings each side—Enough scenery to build one large dressing room on stage to be permanent during the engagement of this show.

It is absolutely necessary that you have all house drops and borders cut on our arrival so make your call accordingly as we must have a clear stage and loft

First nine sets back of your working curtain

- One set of lines 5 ft. 0 inches back of your working curtain
- One set of lines 5 ft. 6 inches back of your working curtain
- One set of lines 6 ft. 0 inches back of your working curtain
- One set of lines 7 ft. 6 inches back of your working curtain
- One set of lines 8 ft. 0 inches back of your working curtain
- One set of lines 9 ft. 0 inches back of your working curtain
- One set of lines 10 ft. 0 inches back of your working curtain
- One set of lines 11 ft. 0 inches back of your working curtain
- One set of lines 12 ft. 0 inches back of your working curtain
- One set of lines 12 ft. 6 inches back of your working curtain
- One set of lines 13 ft. 0 inches back of your working curtain
- One set of lines 13 ft. 6 inches back of your working curtain
- One set of lines 14 ft. 0 inches back of your working curtain
- One set of lines 14 ft. 6 inches back of your working curtain
- One set of lines 15 ft. 0 inches back of your working curtain
- One set of lines 15 ft. 6 inches back of your working curtain
- One set of lines 16 ft. 0 inches back of your working curtain
- One set of lines 16 ft. 6 inches back of your working curtain

ELECTRIC DEPARTMENT

3 1000 Watt Bunch Lights—2 Lights for Change Room
250 Amps. for Company Switch Board

PROPERTY DEPARTMENT

This is the cr

GUY J.

EDITH

SAMPSEL AND REILLY

FASHION-PLATE VOCAL HARMONIZERS.

EN ROUTE

19

Billing.

C. M. Blanchard, presents
Edith
Guy J. Sampsel and Reilly
"Fashion Plate Vocal Harmonizers".

Props.

One "café" chair.

Scenery required.

Clis in one.

Lights cues, on arrival.

BOYLE WOOLFOLK

PRESENTS

"MERRY-GO-ROUND" COMPANY

LINE PLOT

- 8 sets back of tormentors Battens on 2, 3, 4, 7, 8 sets.
- 3 sets between second and third border light. One batten on third set.
- 1 set back of third border light, and batten.
- 1 set in front of fourth border light, and batten.
- 1 set against the back wall for cyk. and spot lines 44 ft. apart and 15 ft. from cyk. set.
- 1 set 4 ft. from cyk. set subject to change.
- One sky border to carry off cyk. Two wood wings to a side and your tormentors.

TRANSFER:

- 1 40 ft., 1 20 ft., and baggage. Please have them meet the train.

Guy Hutton

Carpenter

PROP. PLOT.

"MERRY-GO-ROUND" CO.

- 1 Baby Grand piano.
- 2 Garden benches.
- 1 small wash bench.
- Wood crash.
- Rosin board L.

Carl Green

Props.

December 22/26

To the Manager:

MISS PHYSICAL CULTURE will play your Theatre
for one week commencing on December 25th/26

Her billing is "A Living Tribute to Exercise."

Miss Physical Culture will appear in PERSON
and she will tell the Stout Ladies how to Reduce their
Weight; and the Slender Ones how to Gain, or put on, a
little Weight. Her Act is especially good for Mothers
raising children.

Miss Physical Culture is anxious and ready
to do all she can to help the Manager to make her engage-
ment with them a very successful one at the Box Office.

~~By this same mail I am sending you Photographs
and Lobby Display.~~

I ask but one favor - will you please give me
a dressing room as near the stage as possible.

Have arranged for the contest 2 Dressing rooms
Thank you.

MISS PHYSICAL CULTURE.

I have a 3 Peice Cyclorama Hung 11 Feet back
of your Apening, & a Border & Leg drop in one
need a Carpet to cover stage & a Basket
arrive 7 o'clock x mas morning. Stopping at
"The Texas Hotel —"

F. G. Stage Manager.
Majestic - Ft Worth.
My Dear Sir.

Inclosed
please find Scene plot
Property list Ect - We
require three dressing
rooms -

Cordially Yours.
Mrs Gene Hughes.

Waterloo - Nov. 2/13 -

This C
Errors
mission or
message ha
ninety-five
This k

THEO. N.

REC

Form 2114

COMPANY

THE WORLD

Sender of the following message,
is self liable for errors or delays in trans-
mission, unless otherwise stated below, this
message is not presented in writing within

BROOKS, GENERAL MANAGER

MINEOLA, TEXAS, APRIL 14, 1913.

MGR. MAJESTIC THEATRE,

FTWORTH, TEXAS.

ARRIVING VIA IRON MOUNTAIN THREE HOURS LATE REHEARSAL VERY SIMPLE

MRS. GENE HUGHES

908 AM.

This message is not guaranteed by the sender thereof. The Company will not be liable for damages or statutory penalties in any case where the claim is not presented in writing within
ninety-five days after the cause of action, if any, shall have arisen.

This is an UNREPEATED MESSAGE, and is delivered by request of the sender, under the conditions named above.

THEO. N. VAIL, PRESIDENT

BELVIDERE BROOKS, GENERAL MANAGER

RECEIVED AT

T 29-DA. NT. 10.

MINEOLA, TEXAS, APRIL 14, 1913.

STAGE MANAGER,

MAJESTIC THEATRE,

FTWORTH, TEXAS.

HAVE BAGGAGE MAN MEET US TRAIN NUMBER THREE IRON MOUNTAIN.

MRS. GENE HUGHER,

907 AM.

THE WESTERN UNION TELEGRAPH COMPANY

INCORPORATED

25,000 OFFICES IN AMERICA. CABLE SERVICE TO ALL THE WORLD

This Company TRANSMITS and DELIVERS messages only on conditions limiting its liability, which have been assented to by the sender of the following message. Errors can be guarded against only by repeating a message back to the sending station for comparison, and the Company will not hold itself liable for errors or delays in transmission or delivery of Unrepeated Messages, beyond the amount of tolls paid thereon, nor in any case beyond the sum of Fifty Dollars, at which, unless otherwise stated below, this message has been valued by the sender thereof. The Company will not be liable for damages or statutory penalties in any case where the claim is not presented in writing within ninety-five days after the cause of action, if any, shall have arisen. This is an UNREPEATED MESSAGE, and is delivered by request of the sender, under the conditions named above.

THEO. N. VAIL, PRESIDENT

BELVIDERE BROOKS, GENERAL MANAGER

RECEIVED AT 501 Main St. Ft. Worth, Phone Lamar 4321, Now, ALWAYS OPEN

T 30-DA. NT. 10.

MINEOLA, TEXAS, APRIL 14, 1913.

MGR. MAJESTIC THEATRE,

FTWORTH, TEXAS.

ARRIVING VIA IRON MOUNTAIN THREE HOURS LATE REHEARSAL VERY SIMPLE

MRS. GENE HUGHES

908 AM.

This is an UNREPEATED MESSAGE, and is delivered by request of the sender, under the conditions named above.

THEO. N. VAIL, PRESIDENT

BELVIDERE BROOKS, GENERAL MANAGER

RECEIVED AT 501 Main St. Ft. Worth, Phone Lamar 4321, Now, ALWAYS OPEN

T 29-DA. NT. 10.

MINEOLA, TEXAS, APRIL 14, 1913.

STAGE MANAGER,

MAJESTIC THEATRE,

FTWORTH, TEXAS.

HAVE BAGGAGE MAN MEET US TRAIN NUMBER THREE IRON MOUNTAIN.

MRS. GENE HUGHER,

907 AM.

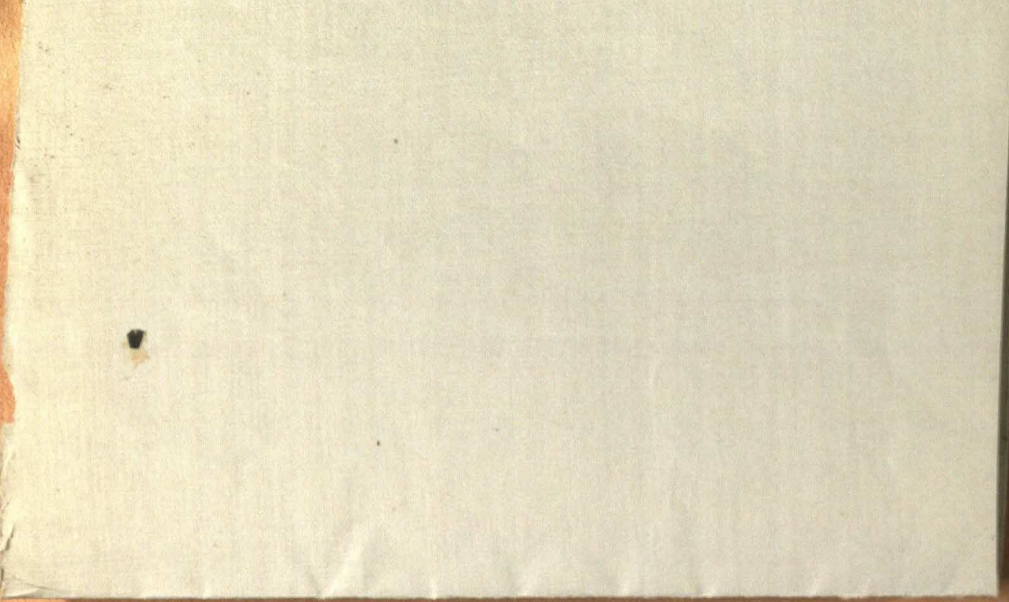

1913
 1883

 30

Form 2114

THE WESTERN UNION TELEGRAPH COMPANY

25,000 OFFICES IN AMERICA. INCORPORATED CABLE SERVICE TO ALL THE WORLD

This Company TRANSMITS and DELIVERS messages only on conditions limiting its liability, which have been assented to by the sender of the following message. Errors can be guarded against only by repeating a message back to the sending station for comparison, and the Company will not hold itself liable for errors or delays in transmission or delivery of Unrepeated Messages, beyond the amount of tolls paid thereon, nor in any case beyond the sum of Fifty Dollars, at which, unless otherwise stated below, this message has been valued by the sender thereof. The Company will not be liable for damages or statutory penalties in any case where the claim is not presented in writing within ninety-five days after the cause of action, if any, shall have arisen. This is an UNREPEATED MESSAGE, and is delivered by request of the sender, under the conditions named above.

THEO. N. VAIL, PRESIDENT

BELVIDERE BROOKS, GENERAL MANAGER

501 Main St. Ft. Worth, Phone Local 4321, Now, ALWAYS OPEN

RECEIVED AT

T 29-DA. NT. 10.

MINEOLA, TEXAS, APRIL 14, 1913.

STAGE MANAGER,

MAJESTIC THEATRE,

FTWORTH, TEXAS.

HAVE BAGGAGE MAN MEET US TRAIN NUMBER THREE IRON MOUNTAIN.

MRS. GENE HUGHER,

907 AM.

Roy—RICE & WERNER—Mary

“ON THE SCAFFOLD”

FOR WEEK COM. ... *Sept 16th*

LINE PLOT

To Stage Manager

DEAR SIR:

WE USE ³ (THREE) SETS OF LINES DIRECTLY IN BACK OF ONE ANOTHER AS FOLLOWS:

² (TWO) SETS OF LINES **5½** FEET BACK OF YOUR “CLOSE IN.”

THESE TWO SETS MUST BE SPOT LINES WITH A **10** FOOT SPREAD (**5** Feet off each side of center line).

NOTE:—THESE SPOT LINES ARE FOR A PAINTER'S SCAFFOLD, TO HOLD ² (TWO) PERSONS WHO DO A LOT OF JUMPING ON SAME, MAKING IT DOUBLE WEIGHT. BE SURE LINES ARE NOT DRY ROTTED AND ARE SPOTTED GOOD AND STRONG TO HOLD. TOTAL WEIGHT 800 POUNDS.

¹ (ONE) SET OF LINES DIRECTLY IN BACK OF SPOT LINES FOR SPECIAL DROP. WOOD BORDER TO MASK ALL THREE SETS OF LINES

WE REQUIRE FIVE MINUTES TO SET AND CAN STRIKE IN ONE MINUTE. TIME OF ACT *14* MINUTES.

ONE DRESSING ROOM.—THANK YOU.

RICE & WERNER.

RICE & WERNER

“ON THE SCAFFOLD”

To Stage Electrician

ALL STAGE LIGHTS UP DURING ACT.

WHITE BUNCH LIGHTS EACH SIDE OF STAGE IN $1\frac{1}{2}$ (IN FRONT OF SPECIAL DROP).

LIGHTS OUT IN BACK OF SPECIAL DROP. THANK YOU. RICE & WERNER.

RICE & WERNER

“ON THE SCAFFOLD”

To Property Man

FOR WEEK COM. *Sept 16th*

OLD PAINT BUCKETS, POTS, VARNISH CANS, ETC. (LARGE AND MEDIUM SIZES). ABOUT A DOZEN AND A HALF IN ALL. ABOVE SHOULD BE EMPTY AND DRY AS THEY TIP OVER ON STAGE.

ONE NEW BRIGHT RED BRICK.

ONE SMALL RUG TO SHAKE OUT OF WINDOW.

DOOR BELL TO RING OFF STAGE. THANK YOU.

RICE & WERNER.

Little Rock

Jan 7 / 1910

Stage Manager

Majestic Theatre

Fort Worth

Dec - 5 - 10

For Norton & Russell

week of Jan 10th we require 4 sets
pieces as follows.

2 set in one back of street drop

1 " " 2

1 " " 2 1/2 or 3.

tie on drops. 32 X 20

Open act in one set, close in your street

Rip

Norton & Russell



HARRY
HOYT
 BARITONE &
M. A. E.
McDONALD
 IN
 HIGH-CLASS
 VAUDEVILLE
 INGENUA



PRESENTING
 THE CLASSY COMEDY PLAYLET
"THE INTERVIEW"

Copyright Class DXXC No. 13009
 Introducing SINGING and VIOLA SPECIALTIES
 Using a \$2,000 Instrument. Elegant Wardrobe. Time of Act, 20 minutes.

Manager Majestic Theatre
 Ft. Worth, Texas.

En Route Mobile, Ala. 3/15 1910

Dear Sir:- We have just been notified by Mr. Muckenfuss that our date at your theatre has been set back two weeks - therefore we open for you week of April 11th instead of Mch. 28th

Hoping to see you April 11th

We remain very respt.

Hoyt + McDonald

Week Mch. 28. Montgomery, Ala
 Apr. 4 - Little Rock, Ark.

Sent you 'photos' + billing sometime ago -
 Just you recd them O. K.

LESLIE MOROSCO & CO.,
PRESENTING
"A MILLION DOLLAR WIFE"

en route.....

4 People,
2 Dressing Rooms,

Stage Manager

Dear Sir:-

Herewith hand you scene and property plot for the
above named act, week of.....

Time of Act 16 Minutes.

SCENE PLOT

Office Set Boxed in 3. Doors Right, Left and Centre.
Interior Backing.

PROPERTY PLOT

Must have

- 1 Flat top Desk.
- 1 Carboy Water Cooler and Stand.
- 1 Desk Telephone.

Ink Well, Papers and books, pens and etc., for top of the desk
We carry everything else

Stage setting is to represent Stock Brokers Office

LESLIE MOROSCO & CO.,
PRESENTING

"A MILLION DOLLAR WIFE"

en route.....

Manager

Dear Sir:-

I enclose herewith Billing Matter and Program
Copy for the above named act which plays your theatre,
week of.....

Photos are being mailed to you under separate cover.
Time of act, 16 minutes.

Large type BILLING MATTER
Leslie Morosco & Co.,
presenting,

Small type - "A MILLION DOLLAR WIFE"
Vaudeville's Comedy Classic

Large type PROGRAM COPY
Leslie Morosco & Co.,
present

Small type - "A MILLION DOLLAR WIFE"

John Rock, a millionaire broker.....THOS. M. MEAD
Nancy, his daughter.....DOROTHY HOLMES
Dick, his son.....JACK MAC BRYDE
Eric Whipple.....LESLIE MOROSCO

Scene: Office of John Rock, Wall Street.

Time: Any Saturday morning

Scene and property Plots have been mailed to your
Stage Manager.

Yours very truly,

Leslie Morosco & Co.

**INTERSTATE
AMUSEMENT
COMPANY**

11th Floor
Majestic Theatre Building
Chicago, Ill.

Name of Act KRAMER

NO. OF PERSONS 2

TIME OF ACT FULL STAGE 11

**IMPORTANT
TO ARTISTS**

department is requested for the

As it is intended to provide Local Managers with every
possible facility for exploiting your act over this Tour,
it is **absolutely imperative** that you fill out the following
carefully and in **detail**, and your co-operation with this
mutual benefit of artist and manager.

INTERSTATE AMUSEMENT CO.

BILLING AND DESCRIPTION OF ACT

(We suggest adopting concise and convincing Billing, devoid of exaggeration.)

KRAMER & SPILLANE,
SENSATIONAL ATHELETES.

SCENE PLOT

Please explain scene you wish minutely and if special entrances, right or
left are desired, draw a pencil diagram. Also if you carry special set mention
number and lengths of battons needed and where to be hung.

WE HANG A DROP IN THREE
AND ONE IN FOUR

PROGRAMME COPY

(Please make this as complete as possible. In ensemble acts the list of
names of all participants is desired. In a sketch the full cast, etc.)

ED SPILLANE

SAM KRAMER

NOTE:--Please state full name of each member of Company.

PROPERTY PLOT

Please make this complete.

1 platform

18 inches high 3 ft. square

1 small center table.

**INTERSTATE
AMUSEMENT
COMPANY**

11th Floor
Majestic Theatre Building
Chicago, Ill.

Name of Act KRAMER & SPILLANE

NO. OF PERSONS 2

NO. OF DRESSING ROOMS 1

TIME OF ACT FULL STAGE 11 min.

TIME OF ACT IN ONE

**IMPORTANT
TO ARTISTS**

As it is intended to provide Local Managers with every possible facility for exploiting your act over this Tour, it is **absolutely imperative** that you fill out the following carefully and in **detail**, and your co-operation with this department is requested for the mutual benefit of artist and manager.

INTERSTATE AMUSEMENT CO.

BILLING AND DESCRIPTION OF ACT

(We suggest adopting concise and convincing Billing, devoid of exaggeration.)

KRAMER & SPILLANE,
SENSATIONAL ATHELETES.

PROGRAMME COPY

(Please make this as complete as possible. In ensemble acts the list of names of all participants is desired. In a sketch the full cast, etc.)

ED SPILLANE

SAM KRAMER

NOTE:--Please state full name of each member of Company.

PROPERTY PLOT
Please make this complete.

SCENE PLOT

Please explain scene you wish minutely and if special entrances, right or left are desired, draw a pencil diagram. Also if you carry special set mention number and lengths of battens needed and where to be hung.

WE HANG A DROP IN THREE
AND ONE IN FOUR

1 platform
18 inches high 3 ft. square
1 small center table.

**INTERSTATE
AMUSEMENT
COMPANY**

11th Floor
Majestic Theatre Building
Chicago, Ill.

Name of Act BRENGK'S MODELS

NO. OF PERSONS 5

NO. OF DRESSING ROOMS 2

TIME OF ACT FULL STAGE 16 minutes

TIME OF ACT IN ONE

**IMPORTANT
TO ARTISTS**

As it is intended to provide Local Managers with every possible facility for exploiting your act over this Tour, it is **absolutely imperative** that you fill out the following carefully and in **detail**, and your co-operation with this department is requested for the mutual benefit of artist and manager.

INTERSTATE AMUSEMENT CO.

BILLING AND DESCRIPTION OF ACT

(We suggest adopting concise and convincing Billing, devoid of exaggeration.)

BRENGK'S MODELS
Studies in
Porcelain & Bronze

PROGRAMME COPY

(Please make this as complete as possible. In ensemble acts the list of names of all participants is desired. In a sketch the full cast, etc.)

BRENGK'S MODELS
Studies in
Porcelain & Bronze

Originator Ernest Brengk

SUBJECTS:

1. Victory of the Arch-Angel
2. The Time
3. Avenging Brothers
4. Vase
5. The Archer
6. Fountain
7. Reaching the Winning Post
8. Liberty Bell

NOTE:—Please state full name of each member of Company.

SCENE PLOT

Please explain scene you wish minutely and if special entrances, right or left are desired, draw a pencil diagram. Also if you carry special set mention number and lengths of battens needed and where to be hung.

Own blue plush-cyclorama: I need for same: Two sets of lines - 12 ft. back of Olio; Two trip lines, right back of Olio; One batten, any length over 20 ft.; One batten 18 ft. long.

PROPERTY PLOT

Please make this complete.

2 kitchen chairs
1 step ladder 5 ft. high
2 large washtubs 4 water pails
One room with hot & cold running water. Three men take a bath after every show, therefore hot water is important. This room must have a drainage & plenty light.

BILLING AND DESCRIPTION OF ACT

(We suggest adopting concise and convincing Billing, devoid of exaggeration.)

Corney
Brookes & Rose
in A Classy Act Carlisle
"A Can of Humor"

A Breezy Mixture of timely wit.

PROGRAMME COPY

(Please make this as complete as possible. In ensemble acts the list of names of all participants is desired. In a sketch the full cast, etc.)

BROOKES & CARLISLE
In a Breezy Mixture of Timely
Wit, Entitled
"A CAN OF HUMOR"

Marion Armor Swift (A Typical American Girl) --Miss Rose Carlisle
Lord Algernon Piper Hope (an impecunious Englishman) in search of American millions ---Mr. Corney Brookes

NOTE:—Please state full name of each member of Company.

SCENE PLOT

Please explain scene you wish minutely and if special entrances, right or left are desired, draw a pencil diagram. Also if you carry special set mention number and lengths of battens needed and where to be hung.

Garden in 3 Green Baise down all through Act. Can close in one (if necessary) with Olio Drop or Drapery.

PROPERTY PLOT

Please make this complete.

Set of Garden Furniture which MUST BE RUSTIC or WICKER, including
Garden Settee 4 Grass Mats and
Garden Table Palms to dress stage
Garden Arm Chair 1 Clean Quart Whiskey
Straight Chair Bottle
1 Glass of Finely
Cracked Ice Every show

**INTERSTATE
AMUSEMENT
COMPANY**

11th Floor
Majestic Theatre Building
Chicago, Ill.

Name of Act BRENGK'S MODELS

NO. OF PERSONS 5

NO. OF DRESSING ROOMS 2

TIME OF ACT FULL STAGE 16 minutes

TIME OF ACT IN ONE

**IMPORTANT
TO ARTISTS**

As it is intended to provide Local Managers with every possible facility for exploiting your act over this Year, it is **absolutely imperative** that you fill out the following carefully and in **detail**, and your co-operation with this department is requested for the mutual benefit of artist and manager.

**INTERSTATE
AMUSEMENT
COMPANY**

11th Floor
Majestic Theatre Building
Chicago, Ill.

Name of Act BROOKES & CARLISLE in "A CAN OF HUMOR"

NO. OF PERSONS TWO

NO. OF DRESSING ROOMS ONE

TIME OF ACT FULL STAGE 15 minutes

TIME OF ACT IN ONE 5 min.

**IMPORTANT
TO ARTISTS**

As it is intended to provide Local Managers with every possible facility for exploiting your act over this Year, it is **absolutely imperative** that you fill out the following carefully and in **detail**, and your co-operation with this department is requested for the mutual benefit of artist and manager.

INTERSTATE AMUSEMENT CO.

BILLING AND DESCRIPTION OF ACT

(We suggest adopting concise and convincing Billing, devoid of exaggeration.)

Corney
Brookes &
in A Classy Act
"A Can of Humor"

Rose
Carlisle

A Breezy Mixture of timely wit.

PROGRAMME COPY

(Please make this as complete as possible. In assembling acts the list of names of all participants is desired. In a sketch the full cast, etc.)

BROOKES & CARLISLE
In a Breezy Mixture of Timely
Wit, Entitled
"A CAN OF HUMOR"
Marion Arbor Swift (a Typical American
Girl) --Miss Rose Carlisle
Lord Algernon Piper Hope (an impecunious
Englishman) in search of American
millions ---Mr. Corney Brookes

NOTE:--Please state full name of each member of Company.

SCENE PLOT

Please explain scene you wish minutely and if special entrances, right or left are desired, draw a pencil diagram. Also if you carry special set mention number and lengths of battens needed and where to be hung.

Garden in 3 Green Baise down all
through Act. Can close in one (if
necessary) with Olio Drop or Drapery.

PROPERTY PLOT

Please make this complete.

Set of Garden Furniture which MUST BE
RUSTIC or WICKER, including
Garden Settee 4 Grass Mats and
Garden Table Palms to dress stage
Garden Arm Chair 1 Clean Quart Whiskey
straight Chair Bottle
1 Glass of Finely
Cracked Ice Every show

**INTERSTATE
AMUSEMENT
COMPANY**

11th Floor
Majestic Theatre Building
Chicago, Ill.

Name of Act

2

1

NO. OF PERSONS

NO. OF DRESSING ROOMS

9-10 min.

TIME OF ACT FULL STAGE

TIME OF ACT IN ONE

**IMPORTANT
TO ARTISTS**

As it is intended to provide Local Managers with every possible facility for exploiting your act over this Tour, it is **absolutely imperative** that you fill out the following carefully and in **detail**, and your co-operation with this department is requested for the mutual benefit of artist and manager.

INTERSTATE AMUSEMENT CO.

BILLING AND DESCRIPTION OF ACT

(We suggest adopting concise and convincing Billing, devoid of exaggeration.)

Ward & Weber

"The Terpsichorean Entertainers."

This act is a singing and dancing act with a very quiet opening and a noisy finish.

PROGRAMME COPY

(Please make this as complete as possible. In ensemble acts the list of names of all participants is desired. In a sketch the full cast, etc.)

Jack Ward and Eddie Weber

"The Terpsichorean Entertainers."

Should prefer the use of full name in billing if lithograph space will allow for it.

NOTE:—Please state full name of each member of Company.

SCENE PLOT

Please explain scene you wish minutely and if special entrances, right or left are desired, draw a pencil diagram. Also if you carry special set mention number and lengths of battons needed and where to be hung.

Garden or Olio in one.

We use both entrances and must have a small space on each side of the stage to change wardrobe.

PROPERTY PLOT

Please make this complete.

One rosin board in each first entrance. Four chairs, to be used off stage for wardrobe.

Light Plot.
Board man, Dark House on opening full up after first exit.

Front man, Light amber or straw spt on B. 1st. entrance at opening of act, keep on till lights full up.

**AMUSEMENT
COMPANY**

11th Floor
Majestic Theatre Building
Chicago, Ill.

NO. OF PERSONS

TWO

NO. OF DRESSING ROOMS

ONE

TIME OF ACT FULL STAGE

NONE

TIME OF ACT IN ONE

10 Min.

**IMPORTANT
TO ARTISTS**

As it is intended to provide Local Managers with every possible facility for exploiting your act over this Tour, it is **absolutely imperative** that you fill out the following carefully and in **detail**, and your co-operation with this department is requested for the mutual benefit of artist and manager.

INTERSTATE AMUSEMENT CO.

BILLING AND DESCRIPTION OF ACT

(We suggest adopting concise and convincing Billing, devoid of exaggeration.)

DICK & DOLLIE MERRINAN.

OFFERING

" A BIT OF BROADWAY PATTERN. "

COMEDY SINGING AND TALKING.

PROGRAMME COPY

(Please make this as complete as possible. In ensemble acts the list of names of all participants is desired. In a sketch the full cast, etc.)

DICK AND DOLLIE MERRINAN.

OFFERING

" A BIT OF BROADWAY PATTERN. "

THE SONG " DREAMS" IS ALL MR. MERRINAN'S ORIGINAL EFFORT. HE CONCEIVED THE IDEA FROM A NIGHTMARE WHICH HE EXPERIENCED.

NOTE:—Please state full name of each member of Company.

SCENE PLOT

Please explain scene you wish minutely and if special entrances, right or left are desired, draw a pencil diagram. Also if you carry special set mention number and lengths of battons needed and where to be hung.

OLIO.

PROPERTY PLOT

Please make this complete.

GARDEN BENCH.

Street in one.

SCENE 5701

PROPERTY 5701

NOTE:—PROPERTY MUST BE KEPT IN THE OFFICE OF COMPANY

**INTERSTATE
AMUSEMENT
COMPANY**

11th Floor
Majestic Theatre Building
Chicago, Ill.

Name of Act DICK & DOLLIE HERRIMAN.

NO. OF PERSONS TWO NO. OF DRESSING ROOMS ONE

TIME OF ACT FULL STAGE NONE TIME OF ACT IN ONE 12 Min.

**IMPORTANT
TO ARTISTS**

As it is intended to provide Local Managers with every possible facility for exploiting your act over this Tour, it is **absolutely imperative** that you fill out the following carefully and in **detail**, and your co-operation with this department is requested for the mutual benefit of artist and manager.

INTERSTATE AMUSEMENT CO.

<p>BILLING AND DESCRIPTION OF ACT (We suggest adopting concise and convincing Billing, devoid of exaggeration.)</p> <p><u>DICK & DOLLIE HERRIMAN.</u> <u>OFFERING</u> <u>" A BIT OF BROADWAY PATTERN. "</u></p> <p><u>COMEDY SINGING AND TALKING.</u></p>	<p>PROGRAMME COPY (Please make this as complete as possible. In ensemble acts the list of names of all participants is desired. In a sketch the full cast, etc.)</p> <p><u>DICK AND DOLLIE HERRIMAN.</u> <u>OFFERING</u> <u>" A BIT OF BROADWAY PATTERN. "</u></p> <p><u>THE SONG " DREAMS " IS ALL MR.</u> <u>HERRIMAN'S ORIGINAL EFFORT. HE</u> <u>CONCEIVED THE IDEA FROM A NIGHT.</u> <u>WALK WHICH HE EXPERIENCED.</u></p> <p>NOTE:—Please state full name of each member of Company.</p>
<p>SCENE PLOT Please explain scene you wish minutely and if special entrances, right or left are desired, draw a pencil diagram. Also if you carry special set mention number and lengths of battons needed and where to be hung.</p> <p><u>CLIO.</u></p>	<p>PROPERTY PLOT Please make this complete.</p> <p><u>GARDEN BENCH.</u></p>

Street in one.

SCENE PLOT

PROPERTY PLOT

BILLING AND DESCRIPTION OF ACT

PROGRAMME COPY

NO. OF PERSONS

NO. OF DRESSING ROOMS

TIME OF ACT FULL STAGE

TIME OF ACT IN ONE

BILLING AND DESCRIPTION OF ACT

PROGRAMME COPY

Chicago, Ill.
Majestic Theatre Building
THE
COMBINATION
AMUSEMENT

TO ARTISTS
IMPORTANT

**INTERSTATE
AMUSEMENT
COMPANY**

Name of Act **SHRINER & RICHARDS**

NO. OF PERSONS **TWO**

NO. OF DRESSING ROOMS **1**

TIME OF ACT FULL STAGE

TIME OF ACT IN ONE **15 min.
15**

Majestic Theatre Building
Chicago, Ill.

BILLING AND DESCRIPTION OF ACT

PROGRAMME COPY

Joe. Doll
SHRINER & RICHARDS
In
" A Few Minutes of Song and Talk "

SAME AS BILLING

SCENE PLOT

PROPERTY PLOT

Street in one.

**INTERSTATE
AMUSEMENT
COMPANY**

11th Floor
Majestic Theatre Building
Chicago, Ill.

UNDINE ANDREWS IN JEROME

NO. OF PERSONS **One**

NO. OF DRESSING ROOMS **One**

TIME OF ACT FULL STAGE

TIME OF ACT IN ONE **10 min.**

**IMPORTANT
TO ARTISTS**

As it is intended to provide Local Managers with every possible facility for exploiting your act over this tour, it is **absolutely imperative** that you fill out the following carefully and in detail, and your co-operation with this department is requested for the mutual benefit of artist and manager.

INTERSTATE AMUSEMENT CO.

BILLING AND DESCRIPTION OF ACT

(We suggest adopting concise and convincing Billing, devoid of exaggeration.)

UNDINE ANDREWS

In

Child Impersonations.

PROGRAMME COPY

(Please make this as complete as possible. In ensemble acts the list of names of all participants is desired. In a sketch the full cast, etc.)

Same as billing.

SCENE PLOT

Please explain scene you wish minutely and if special entrances, right or left are desired, draw a pencil diagram. Also if you carry special set mention number and lengths of battons needed and where to be hung.

Olio in one

PROPERTY PLOT

Please make this complete.

None

PRESS MATERIAL

(A quantity of newspaper matter is requested. In case you have a scrap-book we should like to be permitted to use it. Special appointments are granted any artist who wishes to suggest special means of exploitation. Acts of every nature will be given the same advantage and same attention of this department.)

Undine Andrews is a singing scoubrette who sings and is scoubrettish without straining herself in either capacity. She does it "Just as easy". Her first appearance as a long-frooked little girl is one of the cutest bits of child impersonation that I have ever seen. And her singing and talking throughout is of a high order of merit. But after she changes to the conventional make-up for this sort of stunt I don't care for it so much. I don't know what is the matter with me, but it is a fact that as the waist line of my vest increases with the passing years, I seem to lose my appreciation of fleshings. I am worrying about it, for if it keeps up I will sure be a "Comedy old man".

The show opens with Miss Undine Andrews, and a delatier little girl could not be found anywhere. She has some good sound comedy, sings some catchy songs and has a pleasing voice. She received encore after encor, thereby demonstrating the hit she made.

At least Four (4) complete sets of Photographs must be furnished by each act and sent to the Interstate Amusement Company, 11th Floor, Majestic Theatre Building, Chicago, Ill.

Newspaper Cuts must be sent to each theatre at least two weeks in advance. These Photographs and Cuts will be used only for Little Rock, Fort Worth, Dallas, Houston and San Antonio, and any other towns included in your route must be attended to separately by yourself.

- | | |
|--------------------------------|-------------------|
| Aug. 27 Jacksonville | Oct. 8 Fort Worth |
| Sept. 3 Tampa | 15 Dallas |
| 11 Columbus | 22 Houston |
| 18 Montgomery | |
| 25 Birmingham | |
| Oct. 2 Little Rock & Hot Spgs. | |

OLIO

Faded, illegible text on a piece of paper, possibly a letter or document, with some faint markings and a small tear on the right side.

**INTERSTATE
AMUSEMENT
COMPANY**

Majestic Theatre Building
Chicago, Ill.

Name of Act **HARRY MAYO & ALLMAN**

NO. OF PERSONS **TWO**

NO. OF DRESSING ROOMS **1**

TIME OF ACT FULL STAGE

TIME OF ACT IN ONE **20 min.**

BILLING AND DESCRIPTION OF ACT

PROGRAMME COPY

HARRY MAYO & JACK ALLMAN

"The Melody Kings"

SAME AS BILLING

SCENE PLOT

PROPERTY PLOT

OLIO

**INTERSTATE
AMUSEMENT
COMPANY**Majestic Theatre Bldg.
Chicago, Ill.

Name of Act THE MISSES CAMPBELL

NO. OF MEN WOMEN 2

NO. OF DRESSING ROOMS 1
large or two small
not in basement
TIME OF ACT IN ONE

TIME OF ACT FULL STAGE

BILLING AND DESCRIPTION OF ACT

THE MISSES CAMPBELL
in
Songs of Now and Then
NOTE Do NOT bill as CAMPBELL
SISTERS

PROGRAM COPY

THE MISSES CAMPBELL
Honey and Georgia
in Songs
Writers of "You put the Honey
in Honeymoon" "You're as Dear to
me as Dixie was to Lee". "When
you are near" "Dixie so long
Goodbye" When you
told me that you loved me"
and many others
NOTE DO NOT BILL AS
CAMPBELL SISTERS

SCENE PLOT

time of act 10 minutes in one and one
half place drop REQUIRE

PROPERTY PLOT

grand piano two stools
chevel mirror in dressing room
and as much light as possible
1 piano lamp dress stage
attractively with told furniture
and palms dressing room extra well
lighted

1 blue bunch 1 white bunch
CATCH LINE THE CAMPBELLS ARE COMING"

PRESS MATERIAL

It is now two years since the Misses Campbell ~~after~~ left society behind them and embarked upon a professional career. Durint this tiem they have erected as firm as bulwark in the minds of the amusement public as they have enjoyed in the dignified circle of exlcuvised Washington society. Their naturally ability culture and the atmosphere of refinement has blossomed into a finr art under the warm sunshine of public approval and today these delightful gentoewomen may rest upon their oars fully confident that they have rowed their bark against the tide of life to the source of theRiver ofSuccess. The Misses Campbell are heard in songs and these songs in the most part are their own compositions With the desire to supply themselves with exclusive numbers they undertook the difficult task of writing their own songs. Those songs have been so cuessfull as exemplifite dy bht vogue of "You are as Dear to me as Dixie was to Lee" that various publishers have offered them a rich income for the privilege of publishing their music. These offers however will not be sconsidered until the songs have fully serbed the purpose for which they are intended. The MissesCampbell are pretty girlswith charming manner and indisputable talent.

SCENE PLOT

Garden or palace.
Work in two, close in one
3 1/2 min. if necessary.

PROPERTY PLOT

Carry everything.

The purpose of this document is to provide a detailed description of the act performed by Edgar Berger. The act is titled "Flexible Equilibrism" and is a contortionist performance. It is performed in a garden or palace setting. The act involves balancing on one hand and head, and is performed in two acts, each lasting 3 1/2 minutes. The act is performed in a garden or palace setting. The act is performed in two acts, each lasting 3 1/2 minutes.

BYESS MVALEKIVI

WHICH TIME THE COMBINATION WAS COMING.
 I RISE RATHER I AM THE RATHER

I have been thinking about the act for some time. I have been thinking about the act for some time. I have been thinking about the act for some time.

**INTERSTATE
 AMUSEMENT
 COMPANY**
 Majestic Theatre Building
 Chicago, Ill.

Name of Act **EDGAR BERGER**
 NO. OF PERSONS **ONE**
 TIME OF ACT FULL STAGE

NO. OF DRESSING ROOMS
 TIME OF ACT IN ONE

BILLING AND DESCRIPTION OF ACT

PROGRAMME COPY

EDGAR BERGER
 Flexible Equilibrism
 Contortion, hand and head
 balancing.

EDGAR BERGER
 Flexible Equilibrism.

SCENE PLOT

PROPERTY PLOT

Garden or palace.
 Work in two, close in one
 3 1/2 min. if necessary.

Carry everything.



Name of Act **RYAN & RYAN**
 NO. OF MEN **1** WOMEN **1** NO. OF DRESSING ROOMS
 TIME OF ACT FULL STAGE TIME OF ACT IN ONE **10**

BILLING AND DESCRIPTION OF ACT

PROGRAM COPY

RYAN & RYAN
 Comedy Duo of Eccentric Dancers

same

SCENE PLOT

PROPERTY PLOT

PRESS MATERIAL

A few jokes a little song and some fool them all eccentric dancing this is Ryan and Ryan's description of Ryan and Ryan comedy duo of eccentric dancers who are recognized as Al Entertainers of three continents and half way around the world. Ryan and Ryan are the original three ft. long shoe and eccentric Scotch dancers and many other usual pedal eccentricities owe their existence to their nimble heads and feats.

time of act 16 minutes all in one
 1 man-1 woman 2 dressing rooms
 1-36 ft batten and set of lines in one
 back of olio

PRESS MATERIAL

A comedy gem in a modern art setting is the 1919 edition of **BEHIND THE FRONT** in which Walter De Leon and Mary Davies are appearing this season. This young couple who write and compose their own skits have taken an up to the minute situation and have worked it into one of the biggest laughing hits of the year. A newspaper correspondent and a "soup kitchen" worked in France mistake each other for native French folk and their efforts to make themselves understood in a language neither of them understand or speak produce a steady stream of laughs. De Leon news set song "Oh what a mixup there'll be given them an opportunity for some clever impersonations and Miss Davies graceful dancing and De Leon's eccentric humor complete one of the cleanest and most enjoyable acts at present playing the "big time" theatres.

**INTERSTATE
AMUSEMENT
COMPANY**

Majestic Theatre Bldg.
Chicago, Ill.

Name of Act DELOEN & DAVIES

NO. OF MEN 1 WOMEN 1

NO. OF DRESSING ROOMS 2

TIME OF ACT FULL STAGE

TIME OF ACT IN ONE

BILLING AND DESCRIPTION OF ACT

WALTER DE LEON & MARY DAVIES
in
Their 1919 Edition of
"BEHIND THE FRONT"
(By themselves)
Scene SOMEWHERE IN FRANCE

PROGRAM COPY

same as billing

SCENE PLOT

time of act 16 minutes all in one
1 man-1 woman 2 dressing rooms
1-36 ft batten and set of lines in one
back ofolio

PROPERTY PLOT

1 hall tree

PRESS MATERIAL

A comedy gem in a modern art setting is the 1919 edition of "BEHIND THE FRONT" in which Walter De Leon and Mary Davies are appearing this season. This young couple who write and compose their own skits have taken an up to the minute situation and have worked it into one of the biggest laughing hits of the year. A newspaper correspondent and a "soup kitchen" worked in France mistake each other for native French folk and their efforts to make themselves understood in a language neither of them understand or speak produce a steady stream of laughs. De Leon now set song "Oh what a mixup there'll be given them an opportunity for some clever impersonations and Miss Davies graceful dancing and De Leon's eccentric humor complete one of the cleanest and most enjoyable acts at present playing the "big time" theatres.

**INTERSTATE
AMUSEMENT
COMPANY**Majestic Theatre Bldg.
Chicago, Ill.

Name of Act GUS EDWARDS' ANNUAL SONG REVUE

NO. OF MEN

WOMEN

NO. OF DRESSING ROOMS

TIME OF ACT FULL STAGE

TIME OF ACT IN ONE

BILLING AND DESCRIPTION OF ACT

GUS EDWARDS'S ANNUAL SONG
REVUE

Introducing OLGA COOK
The Young American Prima Donna
Helene Coyne--Premiere Danseuse
Marie Villani-The Neapolitan Tenor
Bruce Morgan and
Marguerite Dana in
"THE FOUNTAIN OF YOUTH"
In Ten Spouts

SCENE PLOT

PROGRAMME CONTINUED

F) "Welcome Home"--Miss Cook and Co.
g-Tableau of the times
Britian-----Miss Martin
Italy--Miss Horlock
Belgium--Miss Starbuck
France--Sig Villani and Miss Nell
zHall
Dixie--Miss Ruth Valle
Our Navy--Mr. Morgan and Miss Dana
Columbia--Miss Moir
The Little Major--Miss Coyne
Finale-"Welcome Home Laddie Boy"
Conceived, composed and written
by Gus Edwards Lyric by Will.
D. Cobb.

CARPENTER'S DEPT. LINE PLOT

6 sets of lines in 1
1 set of lines in front of 2nd border
light 1 set of lines in back of 2nd
border light 2 sets of lines in front
of 3rd border light 2 sets of lines
between 3rd and 4th border light
1 set of lines back of 4th border light
1 set of trip lines 8 ft. from set
of lines in four for trip lines
of cyclorama trip lines to be clear
of house drops.
We carry our own drapery-border and
olio drop- men required to work song
revue-2 men on each side of stage
2 men on floor Property man and
assistant electrician and assistant.

PROPERTY PLOT

12 gold chairs (6) small tables
12 to 18 # square Must be all
the same size 1 desk telephone
1 swivel chair, 1 small flat top
office desk 7 wine glasses
step to audience on right side of
stage.

PROGRAM COPY

GUS EDWARDS' ANNUAL SONG REVUE
Inroducing
OLGA COOK

The Young American Prima Donna
Helen Coyne-Pr miere Danseuse
Marie Villani-The Neapolitan tenor
Bruce Morgan and
Marguerite Dana

in "THE FOUNTAIN OF YOUTH"

In Ten Spouts

THE REVUE HARMONISTS

The Messrs. Mac Sorley, Manning Rowe,
Block and Bozardt

SPOUT 1. (a) Ensemble "I'm looking for the
girl I Met Last Summer" (Scene cafe sky
blue)

(b) Enter Mr. Morgan and Miss Dana

(c) Enter Sig Villani (a girl

a drink and a song

(d) Enter Miss Cook (Listen
to my tra la la(e) "I'm After you" by Mr. Morgan
and Miss Dana

SPOUT 2 Dance "poor little Butterfly"

Miss Coyne (Scene Golden Harvest Days)

SPOUT 3 "When I went to school with you"

The Teacher--Mr. Morgan

Blue Jean Mary--Miss Dana

Yacki Hulap--Miss Kellogg and "Modern"
pupils

SPOUT 4-"A June Night in Naples"

(scene in the shadow of Mr. Vesuvius)

Signor Villani and Neapolitans

"Tarantella" dance by Miss Coyne and

Miss Horlock also Signoranas.

SPOUT 5. "American Never Took "Water"

--by Mr. Mc Sorley and good fellow

SPOUT 6-"The Red Cross Needs you Now"--

---Miss Cook and Nurses

(This red cross song has been donated by
its authors Gus Edwards and Will D.
Cobb to the American Red Cross Society
free from all royalties or financial
returns)

SPOUT 7 Bruce Morgan-"I want to be

Loved like they Love in the Movies"

Scene office of the Film Flam Film

Foundry Director-Morgan---and Movie

Mad-Maids"

SPOUT 8-Dance by Mr. Bruce zMorgan

SPOUT 9: Finale

a-"Uncle Sam's Bouquet"--Miss Cook and
Bouquet of Beautiesb-"That Grand Old Gentleman" by Jack Mac
Sorley and Sailorsc-"Good bye little girl good bye"--Mr.
Bozardt and Miss Martind-"Tipperary"--Mr. Mac Sorley and Miss
Gilberte-"Blue Bells"--Mr. Bozardt and Miss
Lamont

PRESS MATERIAL

1 Upright Piano

In perfect condition

OLIO

**INTERSTATE
AMUSEMENT
COMPANY**

Majestic Theatre Bldg.
Chicago, Ill.

Name of Act **HERMAN**

NO. OF MEN **1** WOMEN

TIME OF ACT FULL STAGE

NO. OF DRESSING ROOMS **1**

TIME OF ACT IN ONE

BILLING AND DESCRIPTION OF ACT

PROGRAM COPY

AL HERMAN
The Black Laugh
The Assassin of Grief and Remorse

same as billing

SCENE PLOT

PROPERTY PLOT

time of act 16 minutes Olio in 1

PRESS MATERIAL

Al Herman has a standing army mobilized to give battle to grief and remorse wherever and whenever the enemy may be encountered. His heavy artillery is a most excellent assortment of yarns and his merchmanship is the ability of an expert comedian which Mr. Herman undoubtedly is. His forces are invariably camouflaged for Mr. Herman is a blackface funster known wherever there is vaudeville theatre as "The Black Laugh". Mr. Herman is one of the few blackfaced comedians who was not a minstrel. He is a vaudevillian and monologist but there are not many men who black up who are as funny as he is.

TRUFA CARDS

(Late Star of "A Broadway Honeycomb")
assisted by
CARL RANDALL

is

Song, Music and Dance

SCENE PLOT

PROPERTY PLOT

Full stage.

**INTERSTATE
AMUSEMENT
COMPANY**

Majestic Theatre Bldg.
Chicago, Ill.

Name of Act **KHARUM**

NO. OF MEN WOMEN

NO. OF DRESSING ROOMS **1**

TIME OF ACT FULL STAGE

TIME OF ACT IN ONE

BILLING AND DESCRIPTION OF ACT

An Extraordinary Novelty
KHARUM
Sensational Persian Pianist
(Steinway Piano used)

PROGRAM COPY

same as billing

SCENE PLOT

Manager's Note:
The Steinway piano
Company furnish **KHARUM** a piano
at all theatres

PROPERTY PLOT

COMPANY

Majestic Theatre Building
Chicago, Ill.

TIME OF ACT FULL STAGE

NO. OF DRESSING ROOMS **2**

TIME OF ACT IN ONE

BILLING AND DESCRIPTION OF ACT

PROGRAMME COPY

EMMA CARUS
(Late Star of "A Broadway Honeymoon")
assisted by
CARL RANDALL

in
Song, Music and Dance

SCENE PLOT

Full stage.

PROPERTY PLOT

**INTERSTATE
AMUSEMENT
COMPANY**

Majestic Theatre Building
Chicago, Ill.

Name of Act **EMMA CARUS**

NO. OF PERSONS **TWO**

NO. OF DRESSING ROOMS **2**

TIME OF ACT FULL STAGE

TIME OF ACT IN ONE

BILLING AND DESCRIPTION OF ACT

PROGRAMME COPY

EMMA CARUS
(Late Star of "A Broadway Honeymoon")
assisted by
CARL RANDALL
in
Song, Music and Dance

SCENE PLOT

PROPERTY PLOT

Full stage.

**INTERSTATE
AMUSEMENT
COMPANY**Majestic Theatre Bldg.
Chicago, Ill.

Name of Act THE MIMIC WORLD OF 1918 and '19

NO. OF MEN WOMEN

NO. OF DRESSING ROOMS

TIME OF ACT FULL STAGE

TIME OF ACT IN ONE

BILLING AND DESCRIPTION OF ACT

Virginia Holding Co. Inc. Presents
THE MIMIC WORLD OF 1918 and '19
with
FRANK MANNING HARRY SHAW
and
FLO RING American's youngest
Prima donna

PROGRAM COPY

Virginia Holding Co. Inc. Presents
THE MIMIC WORLD OF 1918 and '19
with
FRANK MANNING AND HARRY
SHAW FLO RING American's
Youngest Prima Donna

SCENE PLOT

we need(5) sets of lines with battens
as follows
first set-in one and one half 2nd-
set(4) four ft in back of your first
set.
3rd set(4) ft in back of second set
4th set(2) ft back of third set
5th set(2) 2 ft in back of fourth set
We carry three leg drops and one back
drop

The other set of lines used for DOME
which we carry

ELECTRICIAN:

2 bunch lights with red stripes
one bunch light for dressing
room on stage 2 bunch lights with
blue stripes

4 red tungstens for dome(we carry dome)
one portable parlor lamp with dome(practical
and gold center table

FREE MATERIAL:

Flo Ring the little prima donna of the MimicWorld was dis
covered three years ago on the lower east side of New York by the
producer of the show. After three years in vaudeville, she will stop
directly in a Broadway musical comedy next season.

Oscar Hammerstein himself famous operatic impresario, says
that Frank Manning who impersonates him in the MimicWorld offers the
most perfect imitation he has yet seen.

None of the chorus girls in the MimicWorld has yet reached the age
of 20 years. Of the 25 people in the cast there are only two men.

The chorus of the "MimicWorld" is unique in that no girl is allowed
to accept an invitation to go out until one of the four chaperons
carried with the act gives her consent. You'd better stand in with the
chaperons boys if you hope to entertain these girl. The Mimic
World is one of the most remarkable musical comedy organizations
in the world and has the unique distinction of having played for one year
on Broadway. None of the girls in the chorus have ever before
been far from New York.

PROPERTY PLOT

4 vases with flowers
2 gold chairs 2 taborettes
with palms one hammer (large
platform in pit for musical
director 2 small rugs (carpet
2 empty beer boxes one red
medallion

PRESS MATERIAL

One set of lines & batten
in 1, 21x31ft.

We bore four holes ($\frac{1}{4}$ inch)
in floor, five ft. apart.

Box to stand on. Beer case is good

Base drum.

Table to lay props on.

Steps from right hand side stage.

been in New York
 on Broadway. None of the girls in the chorus were ever before
 in the city and was the middle generation of reading by the way one girl
 would be one of the most remarkable players comedy organizations
 elsewhere. She is to be seen in these girls. The music
 called with the girl and her concert. Don't forget to bring the
 to see it in the city to go and see one of the most successful
 The chorus of the "Mimicry" is made up of girls in the city
 of society. Of the 22 people in the cast there are only two men.
 None of the chorus girls in the "Mimicry" has yet reached the age
 most perfect imitation he has yet seen.
 The "Mimicry" is a very successful play in the "Mimicry" office the
 social humor and the humor of the "Mimicry" office the
 success in a Broadway comedy next season.
 Broadway of the "Mimicry" will be in the city and will stop
 covered three weeks ago on the lower east side of New York by the
 The "Mimicry" is the little play done of the "Mimicry" was the

THE MIMICRY:
 and the center stage
 one of the best things that have come (the best)
 a red and white for some (the only one)
 the artist
 room on stage 2 and 11 feet with
 one and 11 feet for dress (the best)
 2 and 11 feet with red and white
 THE MIMICRY:
 and the center stage
 one of the best things that have come (the best)
 a red and white for some (the only one)
 the artist
 room on stage 2 and 11 feet with
 one and 11 feet for dress (the best)
 2 and 11 feet with red and white
 THE MIMICRY:
 and the center stage
 one of the best things that have come (the best)
 a red and white for some (the only one)
 the artist
 room on stage 2 and 11 feet with
 one and 11 feet for dress (the best)
 2 and 11 feet with red and white

THE MIMICRY:
 and the center stage
 one of the best things that have come (the best)
 a red and white for some (the only one)
 the artist
 room on stage 2 and 11 feet with
 one and 11 feet for dress (the best)
 2 and 11 feet with red and white

**INTERSTATE
 AMUSEMENT
 COMPANY**
 Majestic Theatre Building
 Chicago, Ill.

Name of Act **THE SHARROCKS**

NO. OF PERSONS

NO. OF DRESSING ROOMS

TIME OF ACT FULL STAGE

TIME OF ACT IN ONE

BILLING AND DESCRIPTION OF ACT

PROGRAMME COPY

THE SHARROCKS

THE SHARROCKS

"Behind the Grand-stand".

"Behind the Grand Stand"

A "skit" that deals with the
 fair-ground Fortune teller
 Introducing a brilliant display
 of 'second-sight'.

SCENE PLOT

PROPERTY PLOT

One set of lines & batten
 in 1, 21X31ft.

Box to stand on. Beer case is good
 Base dram.
 Table to lay props on.
 Steps from right hand side stage.

We bore four holes (1/2 inch)
 in floor, five ft. apart.

**INTERSTATE
AMUSEMENT
COMPANY**

Majestic Theatre Bldg.
Chicago, Ill.

Name of Act JACK HENRY & GOLDIE COLLINS

NO. OF MEN

WOMEN

NO. OF DRESSING ROOMS

TIME OF ACT FULL STAGE

TIME OF ACT IN ONE

BILLING AND DESCRIPTION OF ACT

JACK HENRY & GOLDIE COLLINS
in
"OH THAT MELODY"
with
WILLIAM POLLARD AND A COMPANY
OF FIFTEEN PEOPLE
Book and Lyrics by Earl Mac Doyle
Music by Walter L. Rosemont

PROGRAM COPY

JACK HENRY & GOLDIE COLLINS
in
"OH THAT MELODY"
with

William Pollard and a Company
of 15 people
Book and Lyrics by Earl Mac Doyle
Music by Walter L. Rosemont
CAST:

Miss Gertrude Van Horn--Miss Goldie Collins
who gives a birthday part and invites,
Mr. Bobby Mac Intosh--Mr. William Pollard
whose dress was delivered by mistake to
Mr. James Hathaway----Mr. Jack Henry
who wins the hearts of his hostess and
Misses Charlotte Cameron--Grace Moore-- Gertrude
Rutledge, Ruby Collins--Betty Dyson--Olga Katterson
Dixie Roberts Margaret Frances

STAGE MANAGER:

We carry our own special set of scenery full stage we require six sets of lines,; We carry our own special set of scenery full stage we require six sets of lines,; Messrs Harry Nelson Hobson Young--Robert Lovan Frank Caruso

1st line close to 1. Bolera-----Jimmy and Ensemble
tormando 2. "There's Something in the name of Dixie--Bobby and Male Quartette
2nd line 4 ft behind 3a Get a girlie of your own"--Gertrude Bobby and Ensemble
first line 4 "There Seems to be something about you-- Gertrude Jimmy and ensemble
3rd line 4 ft behind 4
2nd line 5. Finale----entire company
4th line 3 ft behind
third line

5th line 5 ft behind four line
6th line 7 ft behind fifth line
(these measurements are exact in PRESS MATERIAL baby grand piano (must have it-very essential) one telephone telephone bell one mattress-palms-(potter eight or ten cushions
we need one room for one woman principal one D. R. for 2 men principals one D. R. for chorus men 3 D. R. for chorus girls

ELECTRICIAN:
We need blue border for the last one three bunch lamps or arches with blue gelatine one stage plug for our own lamps (all cues upon arrival.)

REGULAR:
"Oh that Melody" is another girl act. It gains added impersonate however because of its principals. The trio of entertainers of really unusual ability are to be found in the featured players, William Pollard, Jack Henry and Goldie Collins.
"OH THAT MELODY" is a sort of musical plum pudding. It is full of all sorts of good things and just as a Christmas pudding is not complete without the sauce neither would "OH THAT MELODY" be quite the same without the singing and dancing of the trio who interpret the principal roles.

~~1 pedestal~~
~~1 rug (red if possible)~~

Special drop
Carry battens for door in drop.

ELECTRICIAN

2 bunch lights or one large arc lamp on stage.

INTERSTATE AMUSEMENT COMPANY
 Name of Act CUMMINGS & GLADYINGS
 NO. OF PERSONS TWO
 TIME OF ACT FULL STAGE

**INTERSTATE
 AMUSEMENT
 COMPANY**
 Majestic Theatre Building
 Chicago, Ill.

Name of Act **CUMMINGS & GLADYINGS**

NO. OF PERSONS **TWO**

NO. OF DRESSING ROOMS

TIME OF ACT FULL STAGE

TIME OF ACT IN ONE **10 min.**

BILLING AND DESCRIPTION OF ACT

PROGRAMME COPY

CUMMINGS & GLADYINGS
Eccentric Funsters.

Roy **Helen**
CUMMINGS & GLADYINGS
Eccentric Funsters.

SCENE PLOT

PROPERTY PLOT

Special drop
 Carry battens for door
 in drop.

~~1 pedestal~~
 1 rug (red if possible)

ELECTRICIAN

2 bunch lights or one large
 arc lamp on stage.

**INTERSTATE
AMUSEMENT
COMPANY**

Majestic Theatre Bldg.
Chicago, Ill.

Name of Act **FRISCOE**

NO. OF MEN **1** WOMEN

NO. OF DRESSING ROOMS **1**

TIME OF ACT FULL STAGE

TIME OF ACT IN ONE

BILLING AND DESCRIPTION OF ACT

FRISCOE

Wizard of Syncopation

PROGRAM COPY

FRISCOE

Wizard of Syncopation

NOTE: Friscoe is recognized as the first xylophonist to successfully manipulate four hammers at one time playing four part harmony without the use of any mechanical devices.

**INTERSTATE
AMUSEMENT
COMPANY**

Majestic Theatre Bldg.
Chicago, Ill.

Name of Act **JOHN & WINNIE HENNING**
NO. OF MEN **1** WOMEN **1**
TIME OF ACT FULL STAGE

SCENE PLOT

Time of act 10 to 15 minutes all in one plush or olio

PROPERTY PLOT

LIGHTS house dark white spot on right entrance full up when Friscoe comes out

PRESS MATERIAL

Friscoe is a unique example of the modern program of xylophone playing. He is probably the first artist to play four part harmony on this instrument. Friscoe makes a specialty of ragtime. In obtaining some of his syncopated music he is compelled to manipulate four hammers at the same time. This is very much the same as though a violinist played with two bows. Friscoe has not taken up the xylophone as a thing apart. He has made it a life study and has been pleased to discard all other instruments that he might perfect himself upon this. An engaging personality and a sense of humor add greatly to the pleasure of his performance.

PRESS MATERIAL

Sufferers from the blues or a grouch are recommended to see John and Winnie Hennings. John is one of the funniest men in vaudeville. He is an excellent eccentric dancer, his piano playing is of a unique yet musical order and he sings songs that have laughs both in the lines and the execution. His partner Winnie Hennings is a pretty girl a very clever actress and a finished cornet player. Their work is snappy and clean cut, and always finds approval with the audience.

FORM IA 46-10M 1-18 FRANK

**INTERSTATE
AMUSEMENT
COMPANY**

Majestic Theatre Bldg.
Chicago, Ill.

Name of Act **JOHN & WINNIE HENNINGS**

NO. OF MEN **1** WOMEN **1**

NO. OF DRESSING ROOMS **1**

TIME OF ACT FULL STAGE

TIME OF ACT IN ONE

BILLING AND DESCRIPTION OF ACT

JOHN & WINNIE HENNINGS

"The Kill Kare Kouple"

PROGRAM COPY

same as billing

SCENE PLOT

time of act 14 minutes-opening in
full stage-9 minutes C. D. F.
Close in one-5 minutes(street)

PROPERTY PLOT

upright piano with heavy scarf
hall tree
centre table
books
2 light fancy chairs
dress stage nicely

PRESS MATERIAL

Sufferers from the blues or a grouch are recommended to see John and Winnie Hennings.

John is one of the funniest men in vaudeville. He is an excellent eccentric dancer, his piano playing is of a unique yet musical order and he sings songs tat have laughs both in the lines and the execution. His partner Winnie Hennings is a pretty girl a very clever actress and a finished cornet player.

Their work is snappy and clean cut, and always finds approval with the audience.

INTERSTATE AMUSEMENT COMPANY

Majestic Theatre Bldg.
Chicago, Ill.

Name of Act "ON THE HIGH SEAS"

NO. OF MEN

WOMEN

NO. OF DRESSING ROOMS

TIME OF ACT FULL STAGE

TIME OF ACT IN ONE

BILLING AND DESCRIPTION OF ACT

LANGDON MC CORMICK PRESENTS
"ON THE HIGH SEAS"

A Spectacular Melodrama by George Melrose
with
ROBERT HOLDEN and BENNETT JOHNSTONE

PROGRAM COPY

LANGDON MC CORMICK PRESENTS
"ON THE HIGH SEAS"

A Spectacular Melodrama by
George Melrose
with

ROBERT HOLDEN and BENNETT JOHNSTONE

CAST OF CHARACTERS:

Jimmy Weldon--Robert Holden ✓
Frances Landor--Bennett Johnstone ✓
John Landor--George Mackey ✓
Bruce Burkhard---Max Mitchell ✓
Krupton---~~Ben Lamar~~ HERMAN NOBLE ✓
Gilly---~~Alex Gibson~~ Albert Dupont ✓
Boggs---~~Herman Noble~~ C. W. E. MARSHALL ✓
Callahan---~~C. W. Emerson~~ CRAIG ROY LESTON ✓
Carse-----William Dresser
Bergman----Don Mason
Kirby----Fred Mc Alpin
Marsdon-----Edward SMITH

SCENE PLOT

4 men to take in production
one set of lines in front of draperies
one set of lines 7 ft back of olio
6 sets of lines back of olio
1 set lines 10 1/2 back olio
1 set of lines for cyclorama near
as back wall as possible
2 set lines R. & L. for arms
of cyclorama 21 1/2 ft off C.
and 7 ft back of olio
5 dressing rooms
one for lady on ground floor
one for 2 men on ground floor
one for 3 men one flight
3 for 6 men.

PROPERTY PLOT

Ensign Lewis----David Jones
SCENE 1. Aboard the Ocean Trader-"Centur-
ian". SCENE 2. Mid-ocean SCENE 3 Aboard a
U. S. Cruiser SCENE 4. The U. S. Battle
Fleet

STAGE DIRECTOR-----Max Mitchell
Master Mechanist-----Eugene ~~Smith~~ Dupuis
First Electrician----John Lamon
Second Electrician---Joseph Perry
Master of Properties--Fred Church
Technical director--Ray Bidwell
Entire production and effects under the personal
direction of Langdon McCormick.

PRESS MATERIAL

TIME OF ACT 28 minutes full stage
ELECTRICIAN'S PLOTS:

Blue foots -----)

Blue foots borders 1st-2nd and 3rd Must be fresh dipped dark blue
25-60 watt white tungstens for strip lights 25-60 watt red tungstens fresh
lipped. 25-60 watt amber tungstens for strip lights
Steam connection under stage (same principle as Forest Fire)
Cable in gallery to extend to centre at front rail.
Use only BLUE during entire act. Everything white or otherwise front and
back of curtain out during act. Pockets alive all through act.

PROPERTY PLOT

2 darkwood chairs, 1 glass crash one clothes basket

PRESS MATERIAL :

The very last letter in stage realism is claimed to have
attained by Langdon McCormick in his spectacular drama "ON THE HIGH
SEAS" Mr. McCormick is a wizard of scenic spectacles a statement which
may be immediately verified as far as vaudeville is concerned by his recent
production "THE FOREST FIRE" What that little piece did for the timberland
his present playlet does for the high seas excepting the wire sea of the
ocean gives him much greater leeway and instead of one spectacular scene he
has created four.

An intense little drama provides the legitimate reason for the
scenes. The story briefly told concerns a merchant vessel, "CENTURIAN"
which is carrying supplies to enemy submarines. The wireless operator refuses
to play any part in nefarious traffic and is beaten and put in chains. Thus
a youth taken aboard from an open skiff who proves to be a wireless man
is doubly welcome. When the new operator learns of the "CENTURIANS" mission
he attempts to flash the American warships in the vicinity but is caught
by the villainous captain who orders him shot.

**INTERSTATE
AMUSEMENT
COMPANY**

11th Floor
Majestic Theatre Building
Chicago, Ill.

NAME OF ACT

Ad. Carlisle's Dog & Pony

NO. OF PERSONS

NO. OF DRESSING ROOMS

TIME OF ACT FULL STAGE

18 min

TIME OF ACT IN ONE

**IMPORTANT
TO ARTISTS**

As it is intended to provide Local Managers with every possible facility for exploiting your act over this Tour, it is absolutely imperative that you fill out the following carefully and in detail, and your co-operation with this department is requested for the mutual benefit of artist and manager.

INTERSTATE AMUSEMENT CO.

BILLING AND DESCRIPTION OF ACT

(We suggest adopting concise and convincing Billing, devoid of exaggeration.)

*Ad. Carlisle's
Dog Pantomime Co.
Including
TOM - The World's
Greatest Educated
Pony*

PROGRAMME COPY

(Please make this as complete as possible. In ensemble acts the list of names of all participants is desired. In a sketch the full cast, etc.)

NOTE:—Please state full name of each member of Company.

SCENE PLOT

Please explain scene you wish minutely and if special entrances, right or left are desired, draw a pencil diagram. Also if you carry special set mention number and lengths of battons needed and where to be hung.

*Garden or Wood
full stage
I carry special
set of miniature
bridge*

PROPERTY PLOT

Please make this complete.

*10 Common Chairs
2 Kitchen tables
1 Sewing Machine
Glass Crash
Run or steps leading
from stage to orchestra
circle*

PRESS MATERIAL

(A quantity of newspaper matter is requested. In case you have a scrap-book we should like to be permitted to use it. Special appointments are granted any artist who wishes to suggest special means of exploitation. Acts of every nature will be given the same advantage and same attention of this department.)

*I will send press matter as soon
as I can get it forwarded
Kindly look up press matter
sent when I fill in previous
blank and reply with former
contracts*

At least Four (4) complete sets of Photographs must be furnished by each act and sent to the Interstate Amusement Company, 11th Floor, Majestic Theatre Building, Chicago, Ill.

Newspaper Cuts must be sent to each theatre at least two weeks in advance. These Photographs and Cuts will be used only for Little Rock, Fort Worth, Dallas and Houston, and any other towns included in your route must be attended to separately by yourself.

Reply to -

Permanent Address:

Ad. Carlisle St. James N.Y.

[Faint handwritten notes and bleed-through from the reverse side of the page]

**INTERSTATE
AMUSEMENT
COMPANY**

11th Floor
Majestic Theatre Building
Chicago, Ill.

NAME OF ACT
AD CARLISLE'S DOGS & PONY.

NO. OF PERSONS _____ NO. OF DRESSING ROOMS _____

TIME OF ACT FULL STAGE 18 TIME OF ACT IN ONE _____

**IMPORTANT
TO ARTISTS**

As it is intended to provide Local Managers with every possible facility for exploiting your act over this Tour, it is absolutely imperative that you fill out the following carefully and in detail, and your co-operation with this department is requested for the mutual benefit of artist and manager.

INTERSTATE AMUSEMENT CO.

BILLING AND DESCRIPTION OF ACT
(We suggest adopting concise and convincing Billing, devoid of exaggeration.)

AD CARLISLE'S DOG PANTOMIME CO.

FEATURING

"TOM" THE WORLD'S GREATEST

TALKING PONY.

PROGRAMME COPY
(Please make this as complete as possible. In ensemble acts the list of names of all participants is desired. In a sketch the full cast, etc.)

NOTE:—Please state full name of each member of Company.

SCENE PLOT
Please explain scene you wish minutely and if special entrances, right or left are desired, draw a pencil diagram. Also if you carry special set mention number and lengths of battons needed and where to be hung.

GARDEN OR WOOD.

FULL STAGE.

HE CARRIES SPECIAL MINIATURE

VILLAGE SETTING.

PROPERTY PLOT
Please make this complete.

- 10 COMMON CHAIRS
- 2 KITCHEN TABLES
- 1 SECOND HAND TUB
- GLASS CRASJ
- RUN OR STEPS LEADING FROM
- STAGE TO ORCHESTRA CIRCLE.

**INTERSTATE
AMUSEMENT
COMPANY**

11th Floor
Majestic Theatre Building
Chicago, Ill.

BILLY BEARD NAME OF ACT

NO. OF PERSONS 1

NO. OF DRESSING ROOMS 1

TIME OF ACT FULL STAGE 12

TIME OF ACT IN ONE 12

**IMPORTANT
TO ARTISTS**

As it is intended to provide Local Managers with every possible facility for exploiting your act over this Tour, it is absolutely imperative that you fill out the following carefully and in detail, and your co-operation with this department is requested for the mutual benefit of artist and manager.

INTERSTATE AMUSEMENT CO.

BILLING AND DESCRIPTION OF ACT

(We suggest adopting concise and convincing Billing, devoid of exaggeration.)

BILLY BEARD

"THE PARTY FROM THE SOUTH"

PROGRAMME COPY

(Please make this as complete as possible. In ensemble acts the list of names of all participants is desired. In a sketch the full cast, etc.)

BILLY BEARD

"THE PARTY FROM THE SOUTH"

NOTE:—Please state full name of each member of Company.

SCENE PLOT

Please explain scene you wish minutely and if special entrances, right or left are desired, draw a pencil diagram. Also if you carry special set mention number and lengths of battens needed and where to be hung.

Sheet in one

PROPERTY PLOT

Please make this complete.

SCENE PLOT

STAGE MANAGER: We work all in one 14 to 18 minutes Man and woman one dressing room

SCENE PLOT one set of lines in one two battens 36 ft long one large interior backing for door in dro-we carry one drop in one

LIGHT:

All lights full up through act one strong white bunch back of drop lect burns through act house lights on

PROPERTY PLOT

one gold pedestal 3 ft high desk phone on pedestal back of drop hat tree with plenty of pegs

SPOT CURES:

at opening white spot on door in drop till lady comes out, talks to cop second time white spot on door when cop goes in to make change hold till lady goes in makes change and comes out with gold dress hold for few seconds to light up gold dress- 3rd time white spot center for last number follow hold for bows.

PRESS MATERIAL

"Detailed is the name of a bit of vaudeville comedy and songs that offers a clever and humorous limb of the law" and a charming "widow" and around this pair the unserious action of the skit revolves.

J. Frank Holliday essays the "Copy" and makes the character laughable and entertaining while Miss Willette as the widow is just such a one as would win the heart of any man be he uniformed or otherwise.

The comedy of "Detailed" is bright and original and never fails to provoke the audiences of happy expression. The vocal portion of the offering is somewhat in the laughable vein and tuneful as well. The whole contributed genuine gaiety and quite a bit of novelty.

SCENE PLOT

PROBENIA PLOT

[Handwritten signature]

FORM 1A 46-10M 1-18 FRANK

**INTERSTATE
AMUSEMENT
COMPANY**

Majestic Theatre Bldg.
Chicago, Ill.

Name of Act **HOLLIDAY & WILLETTE**

NO. OF MEN WOMEN

NO. OF DRESSING ROOMS

TIME OF ACT FULL STAGE

TIME OF ACT IN ONE

BILLING AND DESCRIPTION OF ACT

HOLLIDAY & WILLETTE
IN
Comedy Absurdity
"DETAILED"

PROGRAM COPY
HOLLIDAY & WILLETTE
in
A Comedy Absurdity
"DETAILED"

SCENE PLOT

STAGE MANAGER: We work all in one 14 to 18 minutes Man and woman one dressing room

SCENE PLOT one set of lines in one two battens 36 ft long one large interior backing for door in dro-we carry one drop in one

LIGHT:
All lights full up through act one strong white bunch back of drop lect burns through act house lights on

PROPERTY PLOT

one gold pedestal 3 ft high
desk phone on pedestal
back of drop hat tree with plenty of pegs

SPOT CURES:

at opening white spot on door in drop till lady comes out, talks to cop second time white spot on door when cop goes in to make change hold till lady goes in makes change and comes out with gold dress hold for few seconds to light up gold dress- 3rd time white spot center for last number follow hold for bows.

PRESS MATERIAL

"Detailed is the name of a bit of vaudeville comedy and songs that offers a clever and humorous limb of the law" and a charming "widow" and around this pair the unserious action of the skit revolves.
J. Frank Holliday essays the "Copy and smkes the character laughable and entertaining while Miss Willette as the widow is just such a one as would win the heart of any man be he uniformed or otherwise.
The comedy of "Detailed" is bright and original and never fails to provoke the audiences of happy expression. The vocal protion of the offering is somewhat in the laughable vein and tuneful as well. The whole contributed genuine gayety and quite a bit of novelty.

**INTERSTATE
AMUSEMENT
COMPANY**

Majestic Theatre Building
Chicago, Ill.

Name of Act **ROSALIND COGHLAN & CO.,**

NO. OF PERSONS **3**

TIME OF ACT FULL STAGE **20 min.**

NO. OF DRESSING ROOMS **3 dressing**

TIME OF ACT IN ONE

BILLING AND DESCRIPTION OF ACT

The Charming Young Actress

-----**ROSALIND COGHLAN**-----
supported by
Richard Pitman
present

-----**THE OBSTINATE MISS GRANGER**-----

A Playlet with many laughs
by
Edgar Allan Woolf

SCENE PLOT

~~The~~ office of MR. BRICE in N. Y. U.

A dark rich oak interior, set in 3.
Door L. 1st opening off and up, inter-
ior backing.

Door R. 3rd. opening off and up, inter-
ior backing.

Window right center in back flat,
house top or sky backing.

Knobs on all doors.

PROGRAMME COPY

C A S T

Henry E. Brice-----Richard Pitman

Jordan King,
His Secretary-----Paul Byron
and

Violet Granger-----Miss COGHLAN

Scene:--Mr. Brice's office in
New York City--Just before Xmas.

- PROPERTY PLOT**
- 1 Large flat top office desk
 - 1 Medium " " " "
 - 1 Large office table
 - 1 Large office bookcase or filing cabinet.
 - 1 Letter press on stand.
 - 1 Stock ticker on stand with tape and waste paper basket.
 - 2 Typewriters, one on stand on stage and one off stage L, practical
 - 2 Swivel office chairs.
 - 5 Ordinary " "
 - 2 Waste baskets
 - 1 Serving tray about 2ft. X 2ft. with champagne glasses.
 - 1 Prop. table off L. 1st entrance.
 - Several R. R. wall maps to hang on set, also calenders.
 - 1 Desk telephone with loud ring bell
 - 1 Rich dark rug down.
 - Pleanty of papers, law books on desks.
 - Also letter files and desk pads.
 - 1 Dark window shade for window up c.
 - Door knobs on doors
 - 1 Coat tree.
 - 1 Doz. neatly tied up packages to represent Xmas presents. Different sizes.

PRESS MATERIAL

WALLACE GALVIN the dexterous deceptionist introduces an egg trick which he has made famous all over the known world. It hardly seems possible that a magician could get so much out of a trick of this character yet Mr. Galvin handles it in such a manner that the audience must perforce be convulsed with laughter as well as completely mystified.

This however is only one of the many tricks shown by Mr. Galvin. His comedy talk with each trick is a peculiar line of patter that always brings out the laughs. His personality is magnetic any audience taking his yes or no's for granted, therein possibly lies his wonderful success.

**INTERSTATE
AMUSEMENT
COMPANY**

Majestic Theatre Bldg.
Chicago, Ill.

Name of Act **WALLACE GALVIN**

NO. OF MEN **1** WOMEN

NO. OF DRESSING ROOMS **1**

TIME OF ACT FULL STAGE

TIME OF ACT IN ONE

BILLING AND DESCRIPTION OF ACT

The Dexterous Deceptionist
WALLACE GALVIN
With His Famous Egg Comedy

PROGRAM COPY

Eggstraordinary
WALLACE GALVIN
Presenting Dexterous Deceptions
Including his celebrated Comedy
Egg Trick

SCENE PLOT

14 minutes Plush or olio
in one dark color preferred

PROPERTY PLOT

24" gold table steps from
steps to audience

PRESS MATERIAL

WALLACE GALVIN the dexterous deceptionist introduces an egg trick which he has made famous all over the known world. It hardly seems possible that a magician could get so much out of a trick of this character yet Mr. Galvin handles it in such a manner that the audience must perforce be convulsed with laughter as well as completely mystified.

This however is only one of the many tricks shown by Mr. Galvin. His comedy talk with each trick is a peculiar line of patter that always brings out the laughs. His personality is magnetic any audience taking his yes or no's for granted, therein possibly lies his wonderful success.

**INTERSTATE
AMUSEMENT
COMPANY**

Majestic Theatre Bldg.
Chicago, Ill.

Name of Act **BERT FITZGIBBON**

NO. OF MEN **1** WOMEN

NO. OF DRESSING ROOMS

1

TIME OF ACT FULL STAGE

TIME OF ACT IN ONE

BILLING AND DESCRIPTION OF ACT

BERT FITZGIBBON
The Original Daffy Dil

PROGRAM COPY

Same as billing

SCENE PLOT

Time of act 12 to 15 minutes
olio in 1

PROPERTY PLOT

PRESS MATERIAL

The word "nut" means a fruit consisting of a kernel enclosed in a hard woody shell. Today "nut" means an eccentric comedian of the extemporaneous style and in this class there is none quite so nutty as Bert Fitzgibbon who describes himself as "The original daffy dil".

Fitzgibbon possess a unique blend of various comedy ingredients. He is at one and the same time a farceur, an eccentric comedian a light comedian, a travesty comedian and a singing comedian and the moods of each flow as freely from his glib tongue as water from a faucet. Fitzgibbon has been described as odd eccentric irregular, anomalous erratic uncommon, singular and whimsical. Above all he is funny and this is the magic wand that opens the doors of success wide to him.

"Between Decks"

Comedy playlet with singing and dancing interpolations. Action takes place on promenade deck of Ocean Liner.

In a Nautical Breeze

"Between Decks"

SCENE PLOT

We carry special scenery.

Require:-

1 set of lines in one
1 " " " " two
5--38 ft. battens
2--7 " "

PROPERTY PLOT

2 kitchen tables
1 " " chair
1 Hat tree
for changes.

THE INTERSTATE AMUSEMENT COMPANY
 110 N. WABASH ST. CHICAGO, ILL.
 Name of Act
 NO. OF PERSONS
 TIME OF ACT FULL STAGE
 NO. OF DRESSING ROOMS
 TIME OF ACT IN ONE

INTERSTATE AMUSEMENT COMPANY

Majestic Theatre Building
Chicago, Ill.

Name of Act **MCCORMACK & IRVING**
 NO. OF PERSONS **TWO**
 NO. OF DRESSING ROOMS **2**
 TIME OF ACT FULL STAGE **18 min. in 2.**
 TIME OF ACT IN ONE

BILLING AND DESCRIPTION OF ACT

PROGRAMME COPY

Jas. Eleanor
MCCORMACK & IRVING
 In a Nautical Breeze
 "Between Decks"
 Comedy playlet with singing and
 dancing interpolations. Action
 takes place on promenade deck of
 Ocean Liner.

Jas. Eleanor
MCCORMACK & IRVING
 In a Nautical Breeze
 "Between Decks"

SCENE PLOT

PROPERTY PLOT

We carry special scenery.
 Require:-
 1 set of lines in one
 1 " " " two
 5--38 ft. battens
 2--7 "

2 kitchen tables
 1 " " chair
 1 Hat tree
 for changes.

**INTERSTATE
AMUSEMENT
COMPANY**

Majestic Theatre Bldg.
Chicago, Ill.

Name of Act **BRENT HAYES**

NO. OF MEN **1** WOMEN

NO. OF DRESSING ROOMS **1**

TIME OF ACT FULL STAGE

TIME OF ACT IN ONE

BILLING AND DESCRIPTION OF ACT

BRENT HAYES
The Master of the Banjo

PROGRAM COPY

same as billing

SCENE PLOT

time of act 15 minutes in one

REQUIRE One fancy chair (gold) and
one small table off

PROPERTY PLOT

1 dressing rooms

PRESS MATERIAL

Brent Hayes is a positive revelation to those who have always considered the banjo and instrument of simple melodies. Mr. Hayes studied music at one of the very best conservatories and when he became interested in the banjo he applied all of his knowledge of technique and harmony to this instrument with the result that he has made the banjo an instrument to be calssed with those usually possessed of the utmost dignity and has made of himself the first banjo virtuoso. It may seem almost an impossibility to associate the banjo with Liszt's difficult rhapsodies. Mr. Hayes manages to execute them as well as Mr. Kriesler does on the violin or Mr. Paderwski on the piano. In fact Mr. Hayes has attained as much prominence with his chosen instrument as any other celebrated musician has with his. His program includes composition of the great masters as well as a number of simply plantation melodies.

SCENE PLOT

OLIO IN ONE.

PROPERTY PLOT

This is a copy of a document from the
 Bureau of Investigation, Washington, D.C.
 containing information regarding the
 activities of certain individuals.
 The document is classified as 'CONFIDENTIAL'
 and contains information the disclosure of
 which could be injurious to the national
 defense. It is intended for the use of
 authorized personnel only.

CONFIDENTIAL

one small copy of
 this document is being retained for
 your information.

1 enclosed copy

copy of document is for you

SCENE PLOT

PROPERTY PLOT

**INTERSTATE
AMUSEMENT
COMPANY**

Majestic Theatre Building
Chicago, Ill.

Name of Act **TROVATO**

NO. OF PERSONS **ONE**

TIME OF ACT-FULL STAGE

NO. OF DRESSING ROOMS **1**

TIME OF ACT IN ONE

BILLING AND DESCRIPTION OF ACT

PROGRAMME COPY

TRAVATO
Genius of The Violin

SAME AS BILLING

SCENE PLOT

PROPERTY PLOT

OLIO IN ONE.

**INTERSTATE
AMUSEMENT
COMPANY**

Majestic Theatre Building
Chicago, Ill.

Name of Act SCOTT & KEANE

NO. OF PERSONS TWO

TIME OF ACT FULL STAGE 17 min.

NO. OF DRESSING ROOMS 2

TIME OF ACT IN ONE

BILLING AND DESCRIPTION OF ACT

Agnes-SCOTT & KEANE-Henry
In
"Drifting"

SCENE PLOT

3 Sky borders
2 wood wings
3 sets lines
1st Set-10 ft. back of olio
2nd set-15 to 20 ft. back of olio
3rd Set-20 to 25 ft. back of olio
1 batten 36 ft.
2 battens (single) 36 ft.
2 battens (side arms) 10 ft.
Carry Cyclorama-2 net
Drops must have clear swing for net
drops.
3 sky borders.

PROGRAMME COPY

Agnes-SCOTT & KEANE-Henry
Present an Episode Entitled
"DRIFTING"
By Agnes Scott, Author of the
"Wall Between"

CAST

The Girl-----Miss Scott
The Man-----Mr. Keane

TIME:-Springtime
PLACE-An Orchard
Scenery by H. R. Law
Properties by
Al Malone

PROPERTY PLOT

Tree Stump
Grass mats (5)
Ground Cloth

LIGHT PLOT

4 Lamps-Arc or Olivette's Amber
Changing to Red at Cue. House
dark throughout. Stage lights full
at opening Front light
Amber flood changing to Red at
Cue-Out at Cue. We carry lamp
for Fly Gallery

PRESS MATERIAL

BILLING AND DESCRIPTION OF ACT

ROUND-THE -WORLD-TOUR
Edwin Bower Hesser
Presents

ROYAL GWENT WELSH MALE SINGERS
Geo. E. Davies, Conductor
CHORUS OF SIXTEEN
"Eisteddfod" ~~Chaxanx~~ Champions of
The World
Twice Commanded by King George and
Queen Mary of England.

"Finest Choir of a Land of Singers"

SCENE PLOT

Best Concert setting, full stage
with fifteen chairs, and Grand
Piano left stage.
No special effects. No changes.

PROGRAMME COPY

AS ATTACHED HERETO

PROPERTY PLOT

NONE.

**INTERSTATE
AMUSEMENT
COMPANY**

Majestic Theatre Building
Chicago, Ill.

Name of Act **GWENT WELSH MALE SINGERS**

NO. OF PERSONS **SIXTEEN**

NO. OF DRESSING ROOMS **6**

TIME OF ACT FULL STAGE

TIME OF ACT IN ONE

BILLING AND DESCRIPTION OF ACT

ROUND-THE -WORLD-TOUR
Edwin Bower Hesser
Presents

ROYAL GWENT WELSH MALE SINGERS
Geo. E. Davies, Conductor
CHORUS OF SIXTEEN
"Eisteddfod" ~~Spaxanx~~ Champions of
The World
Twice Commanded by King George and
Queen Mary of England.

"Finest Chor of a Land of Singers"

SCENE PLOT

Best Concert setting, full stage
with fifteen chairs, and Grand
Piano left stage.
No special effects. No changes.

PROGRAMME COPY

AS ATTACHED HERETO

PROPERTY PLOT

NONE.

**INTERSTATE
AMUSEMENT
COMPANY**

Majestic Theatre Bldg.
Chicago, Ill.

Name of Act PAGE HACK & MACK

NO. OF MEN 2 WOMEN 1

NO. OF DRESSING ROOMS 2

TIME OF ACT FULL STAGE

TIME OF ACT IN ONE

BILLING AND DESCRIPTION OF ACT

PAGE HACK & MACK
Wait for the Finish

PROGRAM COPY

same as billing

SCENE PLOT

time of act 8 minutes C. D. F. fireplace
and french window

PROPERTY PLOT

set of mission furniture
3 pillows one door ballone
coat rack two palms

LIGHTS full up

PRESS MATERIAL

PAGE HACK & MACK are pantomime comedy equilibrists who accomplish a series of stunts that are remarkable. After seeing their act you do not wonder how they do it, but why they have not been killed doing it. Their work is neat and rapid.

BILLING AND DESCRIPTION OF ACT

SEYMOUR & ROBINSON
"The Minx & the Mixer"

PROGRAMME COPY

SCENE PLOT

Garden full stage

PROPERTY PLOT

Strong kitchen table
Garden bench
Thunder sheet
Heavy bump board
Broom
Three Kitchen thairs.

...the ...
...the ...
...the ...
PRESS MATERIAL

FIGURE 1011 00

...the ...
...the ...
...the ...

SCENE PLOT

PROPERTY PLOT

**INTERSTATE
AMUSEMENT
COMPANY**
Majestic Theatre Building
Chicago, Ill.

Name of Act SEYMOUR & ROBINSON

NO. OF PERSONS TWO

NO. OF DRESSING ROOMS 1

TIME OF ACT FULL STAGE 11 min.

TIME OF ACT IN ONE

BILLING AND DESCRIPTION OF ACT

SEYMOUR & ROBINSON
"The Minx & the Mixer"

PROGRAMME COPY

SCENE PLOT

Garden full stage

PROPERTY PLOT

Strong kitchen table
Garden bench
Thunder sheet
Heavy bump board
Broom
Three Kitchen chairs.

**INTERSTATE
AMUSEMENT
COMPANY**

Majestic Theatre Building
Chicago, Ill.

Name of Act **CARL ROSINE & CO.,**

NO. OF PERSONS **TWO**

TIME OF ACT FULL STAGE **10 min.**

NO. OF DRESSING ROOMS **2**

TIME OF ACT IN ONE **7 min.**
if necessary

BILLING AND DESCRIPTION OF ACT

CARL ROSINE & CO.,

Magic

PROGRAMME COPY

ROSINE, the Mysterious

In a Repertoire of Extra-ordinary feats.

SCENE PLOT

Special set in full.

(Carry cyclorama , 2 leg drapoe
1 back drop)

PROPERTY PLOT

Platform from stage to audience
2 gold chairs

PRESS MATERIAL

A magic act of more than passing merit will be seen at the theatre half of next week. It will be presented by Carl Rosine, The Mysterious, who offers a repertoire of extraordinary feats that will baffle old and young. Rosini has appeared in all the first class vaudeville houses of the East as well as West Europe where he achieved established a name for himself. His act is full of startling feats performed in with unusual ease and cleverness and will keep his auditors guessing as to how they are done. Rosini will no doubt provide 10 minutes of wholesome entertainment and should be seen by all in and around

PRESS MATERIAL

The Florenz Duo present a novelty magic act which is entirely different from the usual run of this style act. Mr. Florenz's tricks with coins and cards together with his cigarettes tricks go to make up a very pleasing entertainment, the best part being the cigarette girke which is something new the line of novelty.

FORM IA 46-10M 1-18 FRANK

**INTERSTATE
AMUSEMENT
COMPANY**

Majestic Theatre Bldg.
Chicago, Ill.

Name of Act **FLORENZ DUO**

NO. OF MEN **1** WOMEN **1**

NO. OF DRESSING ROOMS **1**

TIME OF ACT FULL STAGE **12**

TIME OF ACT IN ONE

BILLING AND DESCRIPTION OF ACT

FLORENZ DUO
Something New in Magic

PROGRAM COPY

same as billing

SCENE PLOT

time of act 12 minutes full stage
C. D. .F

PROPERTY PLOT

PRESS MATERIAL

The Florenz Duo present a novelty magic act which is entirely different from the usual run of this style act. Mr. Florenz's tricks with coins and cards together with his cigarettes tricks go to make up a very pleasing entertainment, the best part being the cigarette girke which is something new the line of novelty.

**INTERSTATE
AMUSEMENT
COMPANY**Majestic Theatre Bldg.
Chicago, Ill.

Name of Act "SOMEWHERE IN FRANCE"

NO. OF MEN 4 WOMEN

NO. OF DRESSING ROOMS 2

TIME OF ACT FULL STAGE

TIME OF ACT IN ONE

BILLING AND DESCRIPTION OF ACT

The Sensational War Skit
"SOMEWHERE IN FRANCE"
An Episode of the Trenches
by
John Barclay

PROGRAM COPY

The Sensational War Skit
"SOMEWHERE IN FRANCE"
An Episode of the Trenches
by John Barclay
A Jocular scene between a Canadian a High
lander an Irishman, a cockney in an
advanced observation Post
Scene--a trench on the Western front
Time spring 1915

CAST OF CHARACTERS:

Sergeant Jack Stewart-----Roy Terrey
Private Dan Davis---Charles Walt
Private Paddy Doyle---Phi Doland
Private Jinks-----Cosmo Bellew
Song-There a long Long trail-Elliet(Doyl)
Song"Dun Dee Deedle Dee Dum Dee-Donaldson(jinks)
Song Keep the Home Fires Burning-Novello(stewart)
RECEPTION-"St. Julien"---Carclay(Davis)
Song-"SMileSmileSmile"----(Stewart)

PROPERTY PLOT

N. B. This act was written two years before the
United states entered the war on the side of the
allies Produced and staged by John Barclay and
Toy Torrey Under direction of Irving Shannan

TIME OF SET 22 minutes full stage special
set of lines 14 ft from close in for eye
back 28 ft arms 14 ft set of lines 10 ft
from close in for leg drop 1 set of lines
6 ft from close in for border

PROPS:

2 6 ft step ladders
1-10 ft plank
4-one pail(same as fire bucket)
with holes in sides and bottom
three bricks building bricks
3 beer boxes
3 high pedestals

2 blue bunches(Moonlight blue)
1 blue strip'moonlight blue
blue foots and borders

PRESS MATERIAL

"SOMEWHERE IN FRANCE" the sensational war skit playing at the
theatre is a trench scene depicting life at the front This novel
skit is the result of the observations and a study of war conditions
"OVER THERE" by John Barclay the famous American delineator of English
character types and who plays the part of the Cockney soldier in the skit
The scene is a trench on the western front a Canadian a Highlander
an Irishman and a Cockney are holding an advanced observation post and
bring the lull in the fighting they amuse themselves in the manner we
have read soldiers do. Their humor is unlike anything heard here about
being a production of the present great struggle now going on "Over There"
The act consists of good natured raillery among themselves punctuated by
the singing of songs dear to the hearts of the boys in the trenches.
and the poem "St. Julien" will ever live in the hearts of the Canadian as
"THE CHARGE OF THE LIGHT BRIGADE" lives in the hearts of the British.
The scenic effects are strikingly realistic special attention having
been given to detail.

It is conceded by both press and public that Mr. Barclay has given
vaudeville its most novel and entertaining act sensational without
grotesque. Its success has been emphatic.

SCENE PLOT

C. D. F. DOORS R. L. & C.

PROPERTY PLOT

Piano on the stage INTERNATIONAL
pitch with chairs, tables, etc.
to dress stage.

NOTES:-Two seats to be reserved
at each performance
about 8th row or 2 seats
in box.

A run from stage to centre aisle
important.

INTERSTATE AMUSEMENT COMPANY

Majestic Theatre Bldg.
Chicago, Ill.

Name of Act "SOMEWHERE IN FRANCE"

NO. OF MEN 4 WOMEN

NO. OF DRESSING ROOMS 2

TIME OF ACT FULL STAGE

TIME OF ACT IN ONE

Billings and description of act
 RUTAN'S SONG BIRDS
 A Collection of Nature's Sweetest Song Birds

PROGRAMME COPY
 SAME AS BILLING

PROPERTY PLOT
 Piano on the stage INTERNATIONAL pitch with chairs, tables, etc. to dress stage.
 NOTES:-Two seats to be reserved at each performance about 8th row or 2 seats in box.
 A run from stage to centre aisle important.

INTERSTATE AMUSEMENT COMPANY

Majestic Theatre Building
Chicago, Ill.

Name of Act RUTAN'S SNG BIRDS

NO. OF PERSONS FOUR

NO. OF DRESSING ROOMS 2

TIME OF ACT FULL STAGE

TIME OF ACT IN ONE 18 mins

BILLING AND DESCRIPTION OF ACT

RUTAN'S SONG BIRDS
 A Collection of Nature's Sweetest Song Birds

PROGRAMME COPY

SAME AS BILLING

SCENE PLOT

G. D. F. DOORS R. L. & C.

PROPERTY PLOT

Piano on the stage INTERNATIONAL pitch with chairs, tables, etc. to dress stage.

NOTES:-Two seats to be reserved at each performance about 8th row or 2 seats in box.

A run from stage to centre aisle important.

**INTERSTATE
AMUSEMENT
COMPANY**

Majestic Theatre Bldg.
Chicago, Ill.

Name of Act FRANCIS YEATES & GUS REED

NO. OF MEN 2 WOMEN

NO. OF DRESSING ROOMS 1

TIME OF ACT FULL STAGE

TIME OF ACT IN ONE

BILLING AND DESCRIPTION OF ACT

FRANCIS YATES & GUS REED
in
"DOUBLE CROSSING"

PROGRAM COPY

same as billing

SCENE PLOT

time of act 16 minutes Olio in 1
blue foots at opening upon man's
exit after bass solo all up
including house white spot on
stage right at opening out
on man's exit after bass solo

PROPERTY PLOT

table mirror rug light backing
on left of stage

PRESS MATERIAL

Francis Yates and Gus Reed in "double crossing" do accomplish a bit of deceit you like them all the more for it. The deceit in this at the beginning of the act you are under the impression that Yates and Reed are a man and a woman. Their performance does not progress very far/ however before you find they have been double crossing and the act is composed of two men. Francis Yates as specialized in petticoats for some time. In appearance he makes an exceedingly attractive woman but he does not wear the attire for this purpose It is only to enhance the comedy of the act for he is in reality a travesty impersonator. He and Mr. Reed make DOUBLE CROSSING sixteen minutes of lively entertainment Both men have good voices and both men have a splendid idea of comedy This little act is perfectly constructed and runs with absolute smoothness.

2-12 ft battens

one lamp

PRESS MATERIAL

MILLARD & MARLIN are hardly more than BOY and girl. They are among the youngest vaudevillians outside of those classified as child artists. Both are proteges of Clark and Bergman and they have been practically developed under this directorate. Their experience has been gained in musical comedy as well as in vaudeville. Their last appearance in the former was with Lew Fields "in STEP THIS WAY In vaudeville they are presenting a little musical comedy skit called "FROM BROADWAY TO THE BOWERY"

ON THE 15th of April 1934
including names of the
and the names of the
and the names of the
and the names of the

ON THE 15th of April 1934
including names of the
and the names of the
and the names of the
and the names of the

[Handwritten signature]

**INTERSTATE
AMUSEMENT
COMPANY**

Majestic Theatre Bldg.
Chicago, Ill.

Name of Act **MILLARD & MARLIN**
NO. OF MEN **1** WOMEN **1** NO. OF DRESSING ROOMS **2**
TIME OF ACT FULL STAGE TIME OF ACT IN ONE

BILLING AND DESCRIPTION OF ACT

MILLARD & MARLIN
in
"FROM BROADWAY TO THE BOWERY"

PROGRAM COPY

SAME AS BILLING

SCENE PLOT

Time of act 17 minutes Open in
one close in one
set of lines in 1-1 1/2 and 2
2-12 ft battens

PROPERTY

one baby grand piano
one lamp

PRESS MATERIAL

MILLARD & MARLIN are hardly more than BOY and girl. They are among the youngest vaudevillians outside of those classified as child artists. Both are proteges of Clark and Bergman and they have been practically developed under this directorate. Their experience has been gained in musical comedy as well as in vaudeville. Their last appearance in the former was with Lew Fields "in STEP THIS WAY. In vaudeville they are presenting a little musical comedy skit called "FROM BROADWAY TO THE BOWERY"

**INTERSTATE
AMUSEMENT
COMPANY**Majestic Theatre Bldg.
Chicago, Ill.Name of Act **LAUREL LEE**NO. OF MEN WOMEN **1**NO. OF DRESSING ROOMS **1**

TIME OF ACT FULL STAGE

TIME OF ACT IN ONE

BILLING AND DESCRIPTION OF ACT**LAUREL LEE**
The Chummy Comedienne**PROGRAM COPY**

same as billing

SCENE PLOTtime of act 14 minutes special drop or
olio in one Require-pedestal-telephone-chairLIGHT PLOT 1-4xx red woots white spot
2- white spot
3- everything up
4- everything up**PROPERTY PLOT****PRESS MATERIAL**

In ordinary times Laurel Lee might be compared with a bottle of champagne. She sparkles and effervesces. With the country having gone dry, it is probably better to find some other comparison so whatever it is that sparkles and effervesces that is consistent with temperance, Laurel Lee is like. Miss Lee is thoroughly entertaining. Her songs and dialogue were written by Jean Havez. Her method is of the chummy sort the effect being that she is visiting with her audiences instead of entertaining them.

If consistent with your policy LAUREL LEE is willing to give a "Children's Hour" some time during her local engagement. This can be held in a library the toy department of a large department store or at your theatre and is for children only. A good deal of publicity could be derived if the affair is properly handled. During this hour Miss Lee tells children's satires sing kiddie songs-in fact devotes all of her talent toward making the Children's Hour a child's delight. If you think favorably of this idea communicate with Miss Lee upon her arrival at your theatre.

THE ABOVE FOR THE MANAGER

SCENE PLOT

Street Scene, lights full up.

PROPERTY PLOT

INTERSTATE AMUSEMENT COMPANY

WILLIAM W. BROWN, President
 1000 North Dearborn Street, Chicago, Ill.
 JOHN J. BROWN, Vice President
 1000 North Dearborn Street, Chicago, Ill.
 JAMES W. BROWN, Secretary
 1000 North Dearborn Street, Chicago, Ill.
 HARRY BREEN, Manager
 1000 North Dearborn Street, Chicago, Ill.

PRESS MATERIAL

- 1- Chicago Tribune
- 2- Chicago Daily News
- 3- Chicago Herald Ex-aminer
- 4- Chicago Record
- 5- Chicago Sun

Chicago, Ill., August 1, 1934



Name of Act **HARRY BREEN**

NO. OF PERSONS **ONE MAN**

TIME OF ACT FULL STAGE

NO. OF DRESSING ROOMS **1**

TIME OF ACT IN ONE **18 min.**

BILLING AND DESCRIPTION OF ACT

HARRY BREEN
The Rapid Fire Song Writer.

PROGRAMME COPY

HARRY BREEN
The Singing Comedian
The Rapid Fire Song Writer.

SCENE PLOT

Street Scene, lights full up.

PROPERTY PLOT

**INTERSTATE
AMUSEMENT
COMPANY**

Majestic Theatre Bldg.
Chicago, Ill.

Name of Act **BRONSON & BALDWIN**

NO. OF MEN **1** WOMEN **1**

NO. OF DRESSING ROOMS **2**

TIME OF ACT FULL STAGE

TIME OF ACT IN ONE

BILLING AND DESCRIPTION OF ACT

PERCY BRONSON & WINNIE BALDWIN
in
"1919 Songology"

PROGRAM COPY

same as billing

SCENE PLOT

time of act 20 minutes in one

PROPERTY PLOT

PRESS MATERIAL

The spontaneity with which Percy Bronson and Winnie Baldwin deliver their patter is positively refreshing. Apparently without effort and the personification of neatness and grace, this capable duo pack one quarter of an hour to overflowing with the most entertaining brand of singing dancing and light comedy with their odd style "A 1919 Songology" Leaving the stage only long enough to make several rapid changes of costume. Mr. Bronson and Miss Baldwin were especially engaged by Oliver Morosco for his farce with music "So Long Betty" at the end of the season he formed a vaudeville partnership with Dolly Hackett because illness compelled Miss Baldwin to retire temporarily from the stage. Miss Baldwin is now herself again and once more she and Mr. Bronson are together.

PRESS MATERIAL

George Fox and Zeila Ingraham have taken stock to speak commercially of themselves. The result is the knowledge that they have the right assortment qualities. These they have gone over most carefully and have selected a number of the things they do best and put them together in a melange of music and song which results in a bargain sale. Mr. Fox looks after the mirth and Miss Ingraham the song. A occasionally each encroaches upon the other but the outcome is so pleasing that no one complains not even themselves.

FORM 1A 48-10M 1-18 FRANK

FORM 1A 48-10M 1-18 FRANK

**INTERSTATE
AMUSEMENT
COMPANY**

Majestic Theatre Bldg.
Chicago, Ill.

Name of Act GEORGE FOX & ZELLA INGRAHAM

NO. OF MEN **WOMEN** **NO. OF DRESSING ROOMS**

TIME OF ACT FULL STAGE **TIME OF ACT IN ONE**

BILLING AND DESCRIPTION OF ACT

FOX & INGRAHAM
and ZELLA INGRAHAM

In a Melange of Music and song

PROGRAM COPY

GEORGE FOX & ZELLA INGRAHAM

GEORGE FOX OF HINES & FOX
ZELLA INGRAHAM SISTER OF THE
LATE HERBERT INGRAHAM
Composer of
"Good Bye Rose"
"Ideal of my Dreams"
"All that I ask is Love"
in a Melange of Music and song

SCENE PLOT

work in one in one

PROPERTY PLOT

baby grand piano lamp piano
gold chair pedestal with form

PRESS MATERIAL

George Fox and Zella Ingraham have taken stock to speak commercially of themselves. The result is the knowledge that they have the right assortment qualities. These they have gone over most carefully and have selected a number of the things they do best and put them together in a melange of music and song which results in a bargain sale. Mr. Fox looks after the mirth and Miss Ingraham the song. A coarsion lly each encroaches upon the other but the outcome is so pleasing that no one complains not even themselves.

**INTERSTATE
AMUSEMENT
COMPANY**

Majestic Theatre Building
Chicago, Ill.

Name of Act **MERRIAN'S DOGS**

NO. OF PERSONS **FIVE**

TIME OF ACT FULL STAGE **16 min.**

besides

NO. OF DRESSING ROOMS **2**
room for
dogs.

TIME OF ACT IN ONE

BILLING AND DESCRIPTION OF ACT

MISS TILLIE MERRIAN

Presents her Pantomimic success
entitled
"The Spoiled Honeymoon"
with her troupe of trained
canines.

SCENE PLOT

Act opens in one with body of house
dark. Foots and borders up. FULL ON.
First whistle—foots out.
Second " all stage lights out.
third " " " " B RED
fourth " " " " WHITE
fifth " " " " OUT
sixth " " " " BLUE
seventh " " " " WHITE
eighth " " " " BLUE

LINE PLOT

1 set of lines in one or as near in 1 as possible.
2 " " " " 11ft. back of first set.
3 top battens, three bottom battens
Wood wings to work setting.

PROGRAMME COPY

C A S T

Forester McGrumbler of Lowwood
Maggie Magder (his bride)
Tommy (her lover)
Mike the Dog Innkeeper (her
father)
Bandy-leg his pet dog.
Catch }
Slow } POLICEMEN.
Wiskey }
Faty }
Swift village cut up.
Peasants, Firemen, Street Fair
People, etc.

PROPERTY PLOT

CARRY ALL PROPS.

SCENE PLOT

time of act 10 to 13 minutes full stage
Palace or centre door

LIGHTS full up all through

PROPERTY PLOT

2 centre table
on stand one library table
on hall tree
4 fancy chairs

PRESS MATERIAL

M. NELSON has as many hats as Mr. Dunlap Mr. Knox and Mr. Stetson. While these three gentlemen are content to manufacture head pieces Nelson gives them a new purpose for existence. With a miscellaneous assortment of hats principally of the high variety he cuts didos and funny capers. Nelson is primarily a juggler and as much he is exceedingly fine. He has long since discovered that America's audiences want to laugh Now he offers them the opportunity. The feats are all along comedy lines and while they are none the less difficult for this reason, they have the value of humor. The mysterious pitcher which is not mysterious at all except when in Nelson's hands is a receptacle from which the juggler pours more laughs.

SCENE PLOT
SCENE 1
SCENE 2
SCENE 3
SCENE 4
SCENE 5
SCENE 6
SCENE 7
SCENE 8
SCENE 9
SCENE 10
SCENE 11
SCENE 12
SCENE 13
SCENE 14
SCENE 15
SCENE 16
SCENE 17
SCENE 18
SCENE 19
SCENE 20
SCENE 21
SCENE 22
SCENE 23
SCENE 24
SCENE 25
SCENE 26
SCENE 27
SCENE 28
SCENE 29
SCENE 30
SCENE 31
SCENE 32
SCENE 33
SCENE 34
SCENE 35
SCENE 36
SCENE 37
SCENE 38
SCENE 39
SCENE 40
SCENE 41
SCENE 42
SCENE 43
SCENE 44
SCENE 45
SCENE 46
SCENE 47
SCENE 48
SCENE 49
SCENE 50

SCENE PLOT

SCENE PLOT
SCENE 1
SCENE 2
SCENE 3
SCENE 4
SCENE 5
SCENE 6
SCENE 7
SCENE 8
SCENE 9
SCENE 10
SCENE 11
SCENE 12
SCENE 13
SCENE 14
SCENE 15
SCENE 16
SCENE 17
SCENE 18
SCENE 19
SCENE 20
SCENE 21
SCENE 22
SCENE 23
SCENE 24
SCENE 25
SCENE 26
SCENE 27
SCENE 28
SCENE 29
SCENE 30
SCENE 31
SCENE 32
SCENE 33
SCENE 34
SCENE 35
SCENE 36
SCENE 37
SCENE 38
SCENE 39
SCENE 40
SCENE 41
SCENE 42
SCENE 43
SCENE 44
SCENE 45
SCENE 46
SCENE 47
SCENE 48
SCENE 49
SCENE 50

FORM LA 48-101 1-12 FRANK

**INTERSTATE
AMUSEMENT
COMPANY**

Majestic Theatre Bldg.
Chicago, Ill.

Name of Act M. Nelson

NO. OF MEN 1 WOMEN

NO. OF DRESSING ROOMS 1

TIME OF ACT FULL STAGE

TIME OF ACT IN ONE

BILLING AND DESCRIPTION OF ACT

PROGRAM COPY

M. NELSON
and His Funny Hats and Original
Mysterious Pitcher

same as billing

SCENE PLOT

PROPERTY PLOT

time of act 10 to 13 minutes full stage
Palace or centre door

2 centre table
on stand one library table
on hall tree
4 fancy chairs

LIGHTS full up all through

PRESS MATERIAL

M. NELSON has as many hats as Mr. Dunlap Mr. Knox and Mr. Stetson. While these three gentlemen are content to manufacture head pieces Nelson gives them a new purpose for existence. With a miscellaneous assortment of hats principally of the high variety he cuts didos and funny capers. Nelson is primarily a juggler and as such he is exceedingly fine. He has long since discovered that America's audiences want to laugh. Now he offers them the opportunity. The feats are all along comedy lines and while they are none the less difficult for this reason, they have the value of humor. The mysterious pitcher which is not mysterious at all except when in Nelson's hands is a receptacle from which the juggler pours more laughs.

**INTERSTATE
AMUSEMENT
COMPANY**

11th Floor
Majestic Theatre Building
Chicago, Ill.

NAME OF ACT

LAWRENCE & EDWARDS

NO. OF PERSONS 2

NO. OF DRESSING ROOMS 1

TIME OF ACT FULL STAGE

TIME OF ACT IN ONE 17

**IMPORTANT
TO ARTISTS**

As it is intended to provide Local Managers with every possible facility for exploiting your act over this Tour, it is absolutely imperative that you fill out the following carefully and in detail, and your co-operation with this mutual benefit of artist and manager.

department is requested for the

INTERSTATE AMUSEMENT CO.

BILLING AND DESCRIPTION OF ACT

(We suggest adopting concise and convincing Billing, devoid of exaggeration.)

America's Foremost Talking comedians
LAWRENCE & EDWARDS,
Presenting the Political Satire,
"THE NEW ALDERMAN".

PROGRAMME COPY

(Please make this as complete as possible. In ensemble acts the list of names of all participants is desired. In a sketch the full cast, etc.)

NOTE:—Please state full name of each member of Company.

SCENE PLOT

Please explain scene you wish minutely and if special entrances, right or left are desired, draw a pencil diagram. Also if you carry special set mention number and lengths of battons needed and where to be hung.

ONE SET OF LINES IN ONE OR TWO
TWO 34 foot Battons .
SPECIAL DROP.

PROPERTY PLOT

Please make this complete.

ONE ROLL TOP DESK
" REVOLVING OFFICE CHAIR.
" DESK TELEPHONE
WRITING MATERIAL, ETC.

PRESS MATERIAL

(A quantity of newspaper matter is requested. In case you have a scrap-book we should like to be permitted to use it. Special appointments are granted any artist who wishes to suggest special means of exploitation. Acts of every nature will be given the same advantage and same attention of this department.)

ATTACHED.

At least Four (4) complete sets of Photographs must be furnished by each act and sent to the Interstate Amusement Company, 11th Floor, Majestic Theatre Building, Chicago, Ill.

Newspaper Cuts must be sent to each theatre at least two weeks in advance. These Photographs and Cuts will be used only for Little Rock, Fort Worth, Dallas and Houston, and any other towns included in your route must be attended to separately by yourself.

Permanent Address:

Oil Stage.

THE INTERSTATE AMUSEMENT COMPANY
 1234 N. LAKE STREET
 CHICAGO, ILL.

**INTERSTATE
 AMUSEMENT
 COMPANY**
 Majestic Theatre Building
 Chicago, Ill.

Name of Act **THREE DUFOR BOYS**
 NO. OF PERSONS **THREE**
 TIME OF ACT FULL STAGE

NO. OF DRESSING ROOMS **1**
 TIME OF ACT IN ONE **14 min.**

BILLING AND DESCRIPTION OF ACT

PROGRAMME COPY

THREE DU FOR BOYS
 English Vaudeville Dancers
 Every feature of dancing in a
 Nutshell, the kernel of which
 is Originality.

SCENE PLOT

PROPERTY PLOT

PLUSH of OLIO

1 tables
1 Mirror
3 Chairs
 Rosen board.
 off stage.

**INTERSTATE
AMUSEMENT
COMPANY**

11th Floor
Majestic Theatre Building
Chicago, Ill.

NAME OF ACT

JERE SANFORD

NO. OF PERSONS ONE

NO. OF DRESSING ROOMS ONE

TIME OF ACT FULL STAGE

TIME OF ACT IN ONE 10

**IMPORTANT
TO ARTISTS**

As it is intended to provide Local Managers with every possible facility for exploiting your act over this Tour, it is absolutely imperative that you fill out the following carefully and in detail, and your co-operation with this department is requested for the mutual benefit of artist and manager.

INTERSTATE AMUSEMENT CO.

BILLING AND DESCRIPTION OF ACT

(We suggest adopting concise and convincing Billing, devoid of exaggeration.)

JERE SANFORD,
THE SWEET YODEL SINGER AND
WHISTLER, PRESENTING HIS
CHARACTER STUDY
"THE CHORE BOY"

PROGRAMME COPY

(Please make this as complete as possible. In ensemble acts the list of names of all participants is desired. In a sketch the full cast, etc.)

SCENE PLOT

Please explain scene you wish minutely and if special entrances, right or left are desired, draw a pencil diagram. Also if you carry special set mention number and lengths of battens needed and where to be hung.

WOOD DROP IN ONE.

PROPERTY PLOT

Please make this complete.

ONE WATER PAIL
ONE TREE STUMP.

PRESS MATERIAL

(A quantity of newspaper matter is requested. In case you have a scrap-book we should like to be permitted to use it. Special appointments are granted any artist who wishes to suggest special means of exploitation. Acts of every nature will be given the same advantage and same attention of this department.)

MR. SANFORD IS UNDER CONTRACT WITH THE EDISON PHONOGRAPH CO.
FOR THE NEXT TWO YEARS AND HIS RECORDS ARE ON SALE IN EVERY
CITY AND TOWN IN THE COUNTRY.

At least Four (4) complete sets of Photographs must be furnished by each act and sent to the Interstate Amusement Company, 11th Floor, Majestic Theatre Building, Chicago, Ill.

Newspaper Cuts must be sent to each theatre at least two weeks in advance. These Photographs and Cuts will be used only for Little Rock, Fort Worth, Dallas and Houston, and any other towns included in your route must be attended to separately by yourself.

Permanent Address:

which contains so many different...
impossible to enumerate them. As a preacher of this sort of sermon
Mr. Brownig has it all over other humorists.

SCENE PLOT

PROPERTY PLOT

FORM 1A 48-104 1-18 FRANK

INTERSTATE AMUSEMENT COMPANY
Majestic Theatre Bldg.
Chicago, Ill.

Name of Act JOSEPH L. BROWNING

NO. OF MEN 1 WOMEN

NO. OF DRESSING ROOMS 1

TIME OF ACT FULL STAGE

TIME OF ACT IN ONE

BILLING AND DESCRIPTION OF ACT

JOSEPH L. BROWNING
in
"A Timely Sermon"

PROGRAM COPY

same as billing

SCENE PLOT

time of act about 14 minutes
carries special drop in 1

PROPERTY PLOT

PRESS MATERIAL

Joseph L. Browning D. H. This is a new degree awarded by the College of Comedy and means Doctor of Hilarity" He is a graduate of this college and knows comedy from a wane smile to uproarious laughter. Browning dispenses his laughter in a Timely Sermon which contains so many different kinds of chuckles, that is impossible to enumerate them. As a preacher of this sort of sermon Mr. Browning has it all over other humorists.

**INTERSTATE
AMUSEMENT
COMPANY**

Majestic Theatre Building
Chicago, Ill.

Name of Act **THREE LEIGHTONS**

NO. OF PERSONS **THREE MEN**

NO. OF DRESSING ROOMS **1**

TIME OF ACT FULL STAGE

TIME OF ACT IN ONE

BILLING AND DESCRIPTION OF ACT

PROGRAMME COPY

THE LEIGHTONS
In a comedy singing, talking
and dancing act
entitled
"The Party of the Second Part"

SAME AS BILLING

SCENE PLOT

Special drop in one

Two battens
Must be backed up with another
drop.

IMPORTANT

PROPERTY PLOT

Sure fire gun
Kitchen table
Glass crash.

2nd border light
IMPORTANT two extra heavy battens

one 24" gold table
one gold taboret
on white enambel waste
basket 2 palms
carpet

LIGHT open reds and blue whites
half up after announcement out
at finish of picture

PRESS MATERIAL

Alfred Farrell is the rag man. He doesn't go from house to house collecting rags but he does use rags to better advantage than anyone else does. With an assortment of odd rags he and his associates makes all sorts of pictures. This is accomplished by placing each bit in such a position that it forms as distinct and as perfect a part of a picture as an aptly applied bit of oil painting. In fact unless one saw Farrell build his pictures it would be hard to believe they were not done with a brush.

PALACE OR GARDEN

1 small stand

SIX AMERICAN TUMBLERS
Climax of Agility and
Rapidity.

SAME AS BILLING

SCENE PLOT

palace arch

PROPERTY PLOT

None.

**INTERSTATE
AMUSEMENT
COMPANY**

Majestic Theatre Bldg.
Chicago, Ill.

Name of Act **ALFRED FARRELL & CO.**

NO. OF MEN

WOMEN

NO. OF DRESSING ROOMS

TIME OF ACT FULL STAGE

TIME OF ACT IN ONE

BILLING AND DESCRIPTION OF ACT

PROGRAM COPY

ALFRED FARRELL & CO.
The Picture Man and the Picture Girl

ALFRED FARELL & CO.
Pictures from Rag and any
old thing The Rags are unprepared
How do they stick?

SCENE PLOT

PROPERTY PLOT

Time of act 10 minutes own drop
in one set of lines just back of
2nd border light
IMPORTANT two extra heavy battens

one 24" gold table
one gold taboret
on white enambel waste
basket 2 palms
carpet

LIGHT open reds and blue whites
half up after announcement out
at finish of picture

PRESS MATERIAL

Alfred Farrell is the rag man. He doesn't go from house to house collecting rags but he does use rags to better advantage than anyone else does. With an assortment of odd rags he and his associates makes all sorts of pictures. This is accomplished by placing each bit in such a position that it forms as distinct and as perfect a part of a picture as an aptly applied bit of oil painting. In fact unless one saw Farrell build his pictures it would be hard to believe they were not done with a brush.

PALACE OR GARDEN

1 small stand

SIX AMERICAN TUMBLERS
Climax of Agility and
Rapidity.

SAME AS BILLING

SCENE PLOT

PROPERTY PLOT

palace arch

None.

THE RIGHTS ARE HEREBY GRANTED TO THE
MAGNETIC THEATRE BUILDING
CHICAGO, ILL.

ONE COPY PROOF
ONE COPY PROOF

SCENE PLOT

PROPERTY PLOT

THE RIGHTS ARE HEREBY GRANTED TO THE
MAGNETIC THEATRE BUILDING
CHICAGO, ILL.

**INTERSTATE
AMUSEMENT
COMPANY**

Majestic Theatre Building
Chicago, Ill.

Name of Act **BOLLIGER & REYNOLDS**

NO. OF PERSONS **TWO**

NO. OF DRESSING ROOMS **1**

TIME OF ACT FULL STAGE **13 min.**

TIME OF ACT IN ONE

BILLING AND DESCRIPTION OF ACT

PROGRAMME COPY

BOLLIGER & REYNOLDS
"Fun On The Wire"

SAME AS BILLING

SCENE PLOT

PROPERTY PLOT

PALACE OR GARDEN

1 small stand

SIX AMERICAN TUMBLERS
Climax of Agility and
Rapidity.

SAME AS BILLING

SCENE PLOT

PROPERTY PLOT

palace arch

None.

THESE ARE THE ONLY REAR PICTURES
AND ORDER THEM
IN ONE SET OF THREE INSTEAD OF
THREE OF ONE TO MINIMIZE OUR LOSS

ONE SET OF PICTURES
ONE SET OF PICTURES

PROPERTY PLOT

SCENE PLOT

HOW TO USE THESE
THESE ARE THE ONLY REAR PICTURES
ORDER THEM IN ONE SET OF THREE INSTEAD OF
THREE OF ONE TO MINIMIZE OUR LOSS
THESE ARE THE ONLY REAR PICTURES
ORDER THEM IN ONE SET OF THREE INSTEAD OF
THREE OF ONE TO MINIMIZE OUR LOSS

OFFICE OF THE
PROPERTY PLOT

PROPERTY PLOT

SCENE PLOT

PROPERTY PLOT

**INTERSTATE
AMUSEMENT
COMPANY**

Majestic Theatre Building
Chicago, Ill.

Name of Act **SIX ABDALLAHS**

NO. OF PERSONS

NO. OF DRESSING ROOMS

TIME OF ACT FULL STAGE

TIME OF ACT IN ONE

BILLING AND DESCRIPTION OF ACT

PROGRAMME COPY

SIX ABDALLAHS
Six American Tumblers
Climax of Agility and
Rapidity.

SAME AS BILLING

SCENE PLOT

PROPERTY PLOT

palace arch

None.

FOR STAGE MANAGER,
SCENE PLOT
 CENTER DOOR FANCY IN THREE AND ONE-HALF

PROPERTY LIST

One Strong Round Back Kitchen Chair, Sideboard, Sofa, 2 Easy Chairs, Hat Stand, MISSION FURNITURE PREFERRED, 1/2 Dozen Segar Boxes, 1/2 Dozen Whiskey Bottles, Whiskey Glasses, Decanter, 4 Fancy Pillows, Ferns and Palms, Newspapers, Magazines, Rugs, Baise.

HOME OF RICH BACHELORS

Any article for set will be appreciated.

NOTE:—We carry Table and Tumbling Pad, and use Pad under Baise in TWO.

LA TOY BROTHERS

Week of _____

SCENE PLOT

C. D. F. Richly Furnished.
 in three and one half.

PROPERTY PLOT

One strong round back kitchen chair
 Sideboard, sofa, 2 easy chairs, hat
 stand, MISSION FURNITURE PREFERRED.
 1/2 doz. Segar boxes. 1/2 doz. whisky
 bottles, whiskey glasses, Decanter,
 4 Fancy pillows, Ferns and palms,
 newspapers, Magazines, Rugs, Baise.
 HOME OF RICH BACHELORS.

NOTE:—We carry table and tumbling
 Pad, and use pad under Baise in
 TWO.

AS AT

Garden Drop in three

1 Set of lines in two and a half

1 batten, 36 ft.

3 Battens 16 ft. each.

We carry Out Prop and Two Flat
 Pieces.

LIGHTS

Opening all up, near finish all out.
 And spot on sherriff on cue. Miss
 Lillian, then on girl up stage center
 till sheriff comes out in one and
 looks at drummer. Flash him then
 back to the girl until finish.

Rose-----Raymond Loftus

Bessie McCoy, as the Yama Girl
 in "The Three Twins"—Elsie Taylor
 Lillian Russell, in

"Wildfire"-----Elsie Dingas

THE SHERIFF-----William J. Dooley

(N. B.) KEEP YOUR EYE ON THE
 SHERIFF.

PROPERTY PLOT

2 kitchen tables, 2 benches, wicker
 (important)

Green Ground Cloth " "

1 Wicker table " "

2 wicker chairs, straight back

1 long barrel musket

Two kitchen tables and hall
 tree off stage, for changes.

SCENE PLOT

A good street scene with a side-walk
 if possible.

PROPERTY PLOT

We use no props.

Carry own set, but can work in Palace. 1 Easel.

**INTERSTATE
AMUSEMENT
COMPANY**

Majestic Theatre Building
Chicago, Ill.

Name of Act LA TOY BROS.,

NO. OF PERSONS TWO

NO. OF DRESSING ROOMS 1

TIME OF ACT FULL STAGE 10 - 12 min.

TIME OF ACT IN ONE

BILLING AND DESCRIPTION OF ACT

LA TOY BROS.,
A Pantomime Novelty
An Act full of
Surprises.

PROGRAMME COPY

SAME AS BILLING

SCENE PLOT

C. D. F. Richly Furnished.
in three and one half.

PROPERTY PLOT

One strong round back kitchen chair
Sideboard, sofa, 2 easy chairs, hat
stand, MISSION FURNITURE PREFERRED.
1/2 doz. Segar boxes. 1/2 doz. whisky
bottles, whiskey glasses, Decanter,
4 Fancy pillows, Ferns and palms,
newspapers, Magazines, Rugs, Baise.
HOME OF RICH BACHELORS.
Any article for set will be apprecia-
ted.
NOTE:-We carry table and tumbling
Pad, and use pad under Baise in
TWO.

Garden Drop in three

1 Set of lines in two and a half

1 batten, 36 ft.

2 Battens 16 ft. each.

We carry Out Prop and Two Flat
Pieces.

LIGHTS

Opening all up, near finish all out.
And spot on sherriff on cue. Miss
Lillian, then on girl up stage center
till sheriff comes out in one and
looks at drummer. Flash him then
back to the girl until finish.

Rose-----Raymond Loftus
Bessie McCoy, as the Yama Girl
in "The Three Twins"-Elsie Taylor
Lillian Russell, in
"Wildfire"-----Elsie Dingas
THE SHERIFF-----William J. Dooley

(N. B.) KEEP YOUR EYE ON THE
SHERIFF.

PROPERTY PLOT

2 kitchen tables, 2 benches, wicker
(important)
Green Ground Cloth " "
1 Wicker table " "
2 wicker chairs, straight back
1 long barrel musket

Two kitchen tables and hall
tree off stage, for changes.

SCENE PLOT

A good street scene with a side-walk
if possible.

PROPERTY PLOT

We use no props.

Carry own set, but can work in Palace. 1 Easel.

INTER
AMUSE
COM E

Majestic Thea
Chicag

BILLIN

Ma

AS ATT

Billing and Plot List

MANAGER

THEATRE

BILL AS FOLLOWS

MAX WEILY AND MILISSA TEN EYCK

IN THE LATEST SENSATION
THE GAMBOL OF THE GODS

Programme

MAX WEILY AND MILISSA TEN EYCK

I STORM

II A NOVELTY

III AWAKENING OF GALATEA

SYNOPSIS—PIGMEYOU DREAMS That his masterpeice, Galate^a, comes to life and he follows and dances with her until she commands him to go back to his statue.

The Hoop Dance a flirting novelty

STAGE MANAGER

Two sets of lines. Full stage six foot apart.

ELECTRICIAN

16 Inch Fan. And Blue border in one

PROPERTY MAN

An Easel. Also using carpet

Yours respectfully,

Garden Drop in three
1 Set of lines in two and a half
1 batten, 36 ft.
2 Battens 16 ft. each.

We carry Cut Prop and Two Flat Pieces.

LIGHTS

Opening all up, near finish all out. And spot on sherriff on cue. Miss Lillian, then on girl up stage center till sheriff comes out in one and looks at drummer. Flash him then back to the girl until finish.

Rose-----Raymond Loftus
Bessie McCoy, as the Yama Girl
in "The Three Twins"--Elsie Taylor
Lillian Russell, in
"Wildfire"-----Elsie Dingas
THE SHERIFF-----William J. Dooley

(N. B.) KEEP YOUR EYE ON THE SHERIFF.

PROPERTY PLOT

2 kitchen tables, 2 benches, wicker (important)
Green Ground Cloth " "
1 Wicker table " "
2 wicker chairs, straight back
1 long barrel musket

Two kitchen tables and hall tree off stage, for changes.

SCENE PLOT

A good street scene with a side-walk i possible.

PROPERTY PLOT

We use no props.

Carry own set, but can work in Palace. 1 Easel.

Name of Act WEILY & TEN EYCK

NO. OF PERSONS TWO

NO. OF DRESSING ROOMS 1

TIME OF ACT FULL STAGE 10 min/

TIME OF ACT IN ONE

COUNTY
Majestic Theatre Building
Chicago, Ill.

BILLING AND DESCRIPTION OF ACT

PROGRAMME COPY

Max-WEILY & TEN EYCK-Melissa
On the Latest Dancing
Creation
"THE GAMBOL OF THE GODS"

AS ATTACHED HERETO

SCENE PLOT

PROPERTY PLOT

AS ATTACHED HERETO

COPY ATTACHED

Garden Drop in three
1 Set of lines in two and a half
1 batten, 36 ft.
2 Battens 16 ft. each.
We carry Out Frop and Two Flat
Pieces.

Rose-----Raymond Loftus
Bessie McCoy, as the Yama Girl
in "The Three Twins"-Elsie Taylor
Lillian Russell, in
"Wildfire"-----Elsie Dingas
THE SHERIFF-----William J. Dooley

(N. B.) KEEP YOUR EYE ON THE
SHERIFF.

LIGHTS

Opening all up, near finish all out.
And spot on sherriff on cue. Miss
Lillian, then on girl up stage center
till sheriff comes out in one and
looks at drummer. Flash him then
back to the girl until finish.

PROPERTY PLOT

2 kitchen tables, 2 benches, wicker
(important)
Green Ground Cloth " "
1 Wicker table " "
2 wicker chairs, straight back
1 long barrel musket

Two kitchen tables and hall
tree off stage, for changes.

SCENE PLOT

PROPERTY PLOT

A good street scene with a side-walk
if possible.

We use no props.

Carry own set, but can work in Palace. 1 Easel.

"THE GARDEN OF THE GODS"
CLASSICAL
By the present producer
NEW-YORK & LONDON-NEW-YORK

VS. WILKINSON HEBBLO

BILLING AND DESCRIPTION OF ACT

PROGRAMME COPY

**INTERSTATE
AMUSEMENT
COMPANY**

Majestic Theatre Building
Chicago, Ill.

Name of Act "THE LAWN PARTY"

NO. OF PERSONS TEN

NO. OF DRESSING ROOMS 4

TIME OF ACT FULL STAGE

TIME OF ACT IN ONE

BILLING AND DESCRIPTION OF ACT

H. Bart McHugh
presents
WILLIAM J. DOOLEY
And a company of Versatile Juveniles
in
"THE LAWN PARTY"
A Musical Comedy in Revue Form.

SCENE PLOT

Garden Drop in three
1 Set of lines in two and a half
1 batten, 36 ft.
2 Battens 16 ft. each.
We carry Cut Prop and Two Flat
Pieces.

LIGHTS

Opening all up, near finish all out.
And spot on sherriff on cue. Miss
Lillian, then on girl up stage center
till sheriff comes out in one and
looks at drummer. Flash him then
back to the girl until finish.

PROGRAMME COPY

Cast of Characters in order of
Appearance
Amy Vander Gould---Elsie Dingas
Robt. B. Mantell, as
Richard the Third-Jas. Dougherty
Eva Tanguay, presenting
"I Don't care"--Florence Hughes
David Warfield, in
The Music Master-Harry Anger
Fay Templeton, in 45 Min.
From Broadway--Marie Jacobs
Geo. Cohan, in "The Yankee
Prince"-----Raymond O'Malley
Irene Franklin, featuring
"Red Head"----Florence Hughes

Continued
PROPERTY PLOT

Chauncy Olcott, "Wild Irish
Rose-----Raymond Loftus
Bessie McCoy, as the Yama Girl
in "The Three Twins"-Elsie Taylor
Lillian Russell, in
"Wildfire"-----Elsie Dingas
THE SHERIFF-----William J. Dooley

(N. B.) KEEP YOUR EYE ON THE
SHERIFF.

PROPERTY PLOT

2 kitchen tables, 2 benches, wicker
(important)
Green Ground Cloth " "
1 Wicker table " "
2 wicker chairs, straight back
1 long barrel musket

Two kitchen tables and hall
tree off stage, for changes.

SCENE PLOT

A good street scene with a side-walk
if possible.

PROPERTY PLOT

We use no props.

Carry own set, but can work in Palace. 1 Easel.

Chicago, Ill.

SCENE PLOT

V. HORTON COMPANY IN BOARD ROOM.
THE TVAN BUNNIE
IN
VINT & COMPANY OF AMERICAN TRANSPORT
MIRGIVN 1. DOORER
BLISSERS
H. BULL HONOR

BILLING AND DESCRIPTION OF ACT

PROGRAMME COPY

**INTERSTATE
AMUSEMENT
COMPANY**

Majestic Theatre Building
Chicago, Ill.

Name of Act **THREE CREIGHTON GIRLS**

NO. OF PERSONS **THREE F.**

NO. OF DRESSING ROOMS **1**

TIME OF ACT FULL STAGE

TIME OF ACT IN ONE

BILLING AND DESCRIPTION OF ACT

PROGRAMME COPY

THREE CREIGHTON GIRLS
"Merry Maids of Melody"

SCENE PLOT

PROPERTY PLOT

Upright piano in one,
Two kitchen tables and hall
tree off stage, for changes.

SCENE PLOT

PROPERTY PLOT

A good street scene with a side-walk
if possible.

We use no props.

Carry own set, but can work in Palace. 1 Easel.

SCENE 1701

SCENE 1701
SCENE 1701
SCENE 1701

SCENE 1701

SCENE 1701

BILLING AND DESCRIPTION OF ACT

PROGRAMME COPY

**INTERSTATE
AMUSEMENT
COMPANY**

Majestic Theatre Building
Chicago, Ill.

Name of Act **CAPITAL CITY FOUR**

NO. OF PERSONS **FOUR MEN**

NO. OF DRESSING ROOMS **2**

TIME OF ACT FULL STAGE

TIME OF ACT IN ONE **14 min.**

BILLING AND DESCRIPTION OF ACT

PROGRAMME COPY

CAPITAL CITY FOUR
Quartette Eccentric.
Masters of Harmony and Comedy.

CAPITAL CITY FOUR
Boys from Harmonyland.
Livsey, Dias, Marshall, Vera.

SCENE PLOT

PROPERTY PLOT

A good street scene with a side-walk
if possible.

We use no props.

Carry own set, but can work in Palace. 1 Easel.

SCENE PLOT IN THREE

SCENE PLOT

Beate HOOB, as the Lady GIL
Rose-----
GREGORY OTCOFF, MATTIE HAY

"Red Head"-----STOLANCO HUBBES
Lena HUBBES, JESSIE
BRYNNE,-----ALMOND O. HATT
GEO. CORNELL, JR. The Duke

SCENE PLOT

PROGRAMME COPY

BILLING AND DESCRIPTION OF ACT

PROGRAMME COPY

Chicago, Ill.
Majestic Theatre Building
Chicago, Ill.

**INTERSTATE
AMUSEMENT
COMPANY**

Majestic Theatre Building
Chicago, Ill.

Name of Act **CHALAHOO GUATEMALANS**

NO. OF PERSONS

NO. OF DRESSING ROOMS

TIME OF ACT FULL STAGE

TIME OF ACT IN ONE

BILLING AND DESCRIPTION OF ACT

PROGRAMME COPY

THE CHALAHOO GUATEMALANS
Introducing Native Dances
A Delightful Musical Surprise

SAME AS BILLING

SCENE PLOT

PROPERTY PLOT

Carry own set, but can work in Palace. 1 Easel.

INTERSTATE AMUSEMENT COMPANY
 11th Floor
 Majestic Theatre Building
 Chicago, Ill.

Name of Act CHAS. W. BOWSER & CO
 NO. OF PERSONS 3 NO. OF DRESSING ROOMS _____
 TIME OF ACT FULL STAGE _____ TIME OF ACT IN ONE _____

IMPORTANT TO ARTISTS

As it is intended to provide Local Managers with every possible facility for exploiting your act over this Tour, it is **absolutely imperative** that you fill out the following carefully and in **detail**, and your co-operation with this department is requested for the mutual benefit of artist and manager.

INTERSTATE AMUSEMENT CO.

BILLING AND DESCRIPTION OF ACT
 (We suggest adopting concise and convincing Billing, devoid of exaggeration.)

CHAS. W. BOWSER
 &
 COMPANY.

PROGRAMME COPY
 (Please make this as complete as possible. In ensemble acts the list of names of all participants is desired. In a sketch the full cast, etc.)

CHAS. W. BOWSER & COMPANY
 IN
 "SUPERSTITION"
 Big Jim Kingston, the politician-----
 Chas. W. Bowser
 Flotwau, the astologist-----
 Florence Auer.
 Tredlowe, the reporter-----
 Maxfield Moree
 Scene-Madam Floteau's reception room
 Place New York.

NOTE:--Please state full name of each member of Company.

SCENE PLOT
 Please explain scene you wish minutely and if special entrances, right or left are desired, draw a pencil diagram. Also if you carry special set mention number and lengths of battons needed and where to be hung.

Center Door Chamber. Street or Garden Backing.
 12 ft. flat with door or arch
 2ings with doors, (doors off)
 Plain Wings.
 N.B. We carry drapery for this entire set.

PROPERTY PLOT
 Please make this complete.

1 flat top library table
 3 library chairs Medallion or
 2 pedestals. carpet down. The fur-
 1 table 20x24 niture must be mission
 1 settee or dark wood (very well
 1 high back library chair (set)
 1 tabourette N.B. We carry portierres.
 1 green blotting pad, for (curtains, rods.
 desk telephone (decorations, table cover
 3 rugs 4 sofa pillows (and all properties
 1 telephone bell to ring (except above
 off stage (on cue) (mentioned).
 1 pt. of wood alcohol
 1 lady's writing desk must
 be fine
 1 stand or table 16x18

Martin Ferreri

BILLING AND DESCRIPTION OF ACT

of the wind mill hat

SCENE PLOT
 Please explain scene you wish minutely and if special entrances, right or left are desired, draw a pencil diagram. Also if you carry special set mention number and lengths of battons needed and where to be hung.

In one

NOTE:--Please state full name of each member of Company.

PROPERTY PLOT
 Please make this complete.

IN
A
CO
Maje

Scene plot. Fancy center door in three.

Props One fancy chair.

Two Nozin boards.

INTERSTATE
AMUSEMENT
COMPANY
176 East
Market Street
Chicago, Ill.

I remain

respectfully yours

Martin Ferreri.

of the - any - only - the
wind mill hat.

SCENE PLOT

Please explain scene you wish minutely and if special entrances, right or left are desired, draw a pencil diagram. Also if you carry special set mention number and lengths of battens needed and where to be hung.

NOTE:—Please state full name of each member of Company.

PROPERTY PLOT

Please make this complete.

In one

IN
A
CO
Maje

[Faint, illegible handwriting on a piece of paper pasted onto the form.]

**INTERSTATE
AMUSEMENT
COMPANY**
11th Floor
Majestic Theatre Building
Chicago, Ill.

NAME OF ACT Florence Nilson

NO. OF PERSONS (1) NO. OF DRESSING ROOMS (1)

TIME OF ACT FULL STAGE _____ TIME OF ACT IN ONE _____

**IMPORTANT
TO ARTISTS**

As it is intended to provide Local Managers with every possible facility for exploiting your act over this Tour, it is absolutely imperative that you fill out the following carefully and in detail, and your co-operation with this department is requested for the mutual benefit of artist and manager.

INTERSTATE AMUSEMENT CO.

BILLING AND DESCRIPTION OF ACT
(We suggest adopting concise and convincing Billing, devoid of exaggeration.)

*The girl with the
wind mill hat.*

PROGRAMME COPY
(Please make this as complete as possible. In ensemble acts the list of names of all participants is desired. In a sketch the full cast, etc.)

NOTE:—Please state full name of each member of Company.

SCENE PLOT
Please explain scene you wish minutely and if special entrances, right or left are desired, draw a pencil diagram. Also if you carry special set mention number and lengths of battons needed and where to be hung.

In one

PROPERTY PLOT
Please make this complete.

